

- En Instruction Manual
- De Bauanleitung
- Fr Manuel de montage

HB WORLD SPEC

WORLD SPEC 1/8 SCALE 4WD ELECTRIC BUGGY



THANK YOU!

Thank you for selecting this HB Racing product! This kit is designed to be fun to drive and uses top quality parts for durability and performance. The instruction manual you are reading was designed to be easy to follow yet thorough in its explanations. HB Racing wants you to enjoy driving your new HB Racing product. If you come across any problems or need some help getting through a step, give us a call and we will do our very best to help you. You can also contact us on the internet at www.hbracing.com

**This is a high performance R/C kit, and it requires regular maintenance for best performance. If you don't do regular maintenance the performance will suffer. HB Racing has all the necessary parts and accessories available to keep your car performing at its best.*

The caution or attention symbols will warn you about steps that can be very dangerous. Please read and understand the instructions carefully before proceeding.



Caution

Failure to follow these instructions can damage your kit, and cause serious bodily injury or death.



Attention

Failure to follow these instructions can cause injury to yourself or others. You might also cause property damage or damage to your kit.



Caution

Before Running

- Please read manual with parent or guardian (responsible adult).

Before Operating

- Make sure that all screws and nuts are properly tightened.
- Always use fresh batteries for transmitter and receiver to avoid losing control of the model.
- Make sure no one else is using the same radio frequency as you are using.
- Please confirm the range of the radio operation.

During Running

- Please do not run on a public street, this could cause serious accidents, personal injuries and/or property damage.
- Please do not run near pedestrians or small children.
- Please do not run in small or confined areas.

After Running

- Turn OFF receiver first, then turn OFF transmitter. This will prevent the car from losing control.

Battery Safety

- Please be careful when handling the battery. It will be hot after running. If the wire is frayed, a short circuit can cause a fire.

4 TIME WORLD CHAMPIONS



www.HBRACING.com

#HBHEATWAVE

DANKE!

Vielen Dank, dass Sie sich für HB Racing entschieden haben! Dieses Auto soll Spaß machen und verwendet nur hochwertige Materialien für beste Leistungen und Haltbarkeit. Die Anleitung, die Sie gerade lesen, ist einfach zu verstehen und dabei sehr ausführlich. HB Racing will, dass Sie Erfolg und Spaß mit Ihrem neuen Modell haben! Falls es dennoch einmal zu Problemen kommen sollte, melden Sie sich bei uns. Wir werden alles in unserer Macht stehende tun, um zu helfen. Sie können uns auch gerne unter www.hbracing.com kontaktieren.

•Dies ist ein hochleistungs RC-Auto und benötigt regelmäßige Wartung. Wenn Sie diese Wartungsarbeiten nicht durchführen wird die Leistung des Autos darunter leiden. Alle zur Wartung benötigten Teile sind bei HB Racing erhältlich.

Die Warnsymbole weisen Sie auf gefährliche Bauabschnitte hin.

Bitte lesen und verstehen Sie die Anweisungen bevor Sie sie durchführen.



Warnhinweise

Wenn Sie diesen Anweisungen nicht folgen, können Sie oder Ihr Auto Schäden davontragen.



Achtung

Wenn Sie diesen Anweisungen nicht folgen, können Sie oder andere verletzt werden. Es kann auch sein, dass dabei Sachschaden an anderen Dingen oder Ihrem Auto entsteht.



Warnhinweise

Vor dem Fahren

- Bitte lesen Sie die Anleitung (zusammen mit einem Erwachsenen/Erziehungsberechtigten).

Vor dem Betrieb

- Stellen Sie sicher, dass alle Schrauben und Muttern korrekt sitzen.
- Verwenden Sie immer volle Batterien für den Sender und Empfänger, um Empfangsstörungen zu vermeiden.
- Stellen Sie sicher, dass niemand anderes die gleiche Frequenz verwendet.
- Überprüfen Sie die Reichweite der RC-Anlage.

Während dem Fahren

- Fahren Sie nicht auf öffentlichen Straßen. Dies kann zu schweren Unfällen mit Personen- oder Sachschäden führen.
- Fahren Sie nicht in der Nähe von Fußgängern oder kleinen Kindern.
- Fahren Sie nicht auf zu kleinen oder zu eng begrenzten Geländen.

Nach dem Fahren

- Schalten Sie den Empfänger aus, dann erst den Sender. Dies verhindert, dass das Auto außer Kontrolle gerät.

Hinweise zum Fahrakku

- Geben Sie im Umgang mit dem Fahrakku bitte Acht. Er ist nach dem Fahren sehr heiß. Falls die Kabel beschädigt sind, kann ein Kurzschluss ein Feuer auslösen.

MERCI!

Merci d'avoir choisi ce produit HB Racing! Ce kit a été conçu pour être amusant à conduire, et utilise des pièces de la plus haute qualité pour la longévité et les performances. Le manuel d'utilisation qui est entre vos mains a été conçu pour vous fournir des explications faciles à suivre mais complètes. HB Racing espère que vous aurez plaisir à piloter votre nouveau kit radio-commandé. Si vous rencontrez des problèmes ou si vous avez besoin d'aide pour une étape, appelez-nous et nous ferons de notre mieux pour vous aider. Vous pouvez aussi nous contacter par Internet sur www.hbracing.com.

•Ceci est un kit radio-commandé de hautes performances, et requiert un entretien régulier pour donner le meilleur de lui-même. Si vous n'effectuez pas un entretien régulier, les performances en souffriront. HB Racing a toutes les pièces et les accessoires nécessaires pour maintenir les performances de votre véhicule à leur meilleur niveau.

Les symboles attirant votre attention vous avertiront des étapes qui peuvent être très dangereuses.

Veillez lire soigneusement les instructions et bien les comprendre avant toute utilisation.



Précautions

En ne suivant pas ces instructions vous pourriez endommager votre kit, et provoquer de sérieux dégâts corporels ou même mortels.



Attention

En ne suivant pas ces instructions vous pourriez vous blesser vous-même ou blesser d'autres personnes. Vous pourriez également provoquer des dégâts matériels ou endommager votre kit.



Précautions

Avant de mettre en marche

- Veuillez lire le manuel avec un parent ou un adulte responsable.

Avant de mettre en marche

- Vérifiez que toutes les vis et les boulons sont correctement serrés.
- Utilisez toujours des batteries nouvellement chargées pour l'émetteur et le récepteur afin d'éviter de perdre le contrôle du véhicule.
- Vérifiez que personne d'autre n'utilise la même fréquence radio que vous.
- Vérifiez le champ d'action du fonctionnement de la radio.

Pendant le fonctionnement

- Ne faites pas fonctionner sur une voie publique, cela pourrait provoquer des accidents graves, des blessures corporelles et/ou des dommages aux biens.
- Ne faites pas fonctionner à proximité de piétons ou d'enfants en bas âge.
- Ne faites pas fonctionner dans des lieux petits ou fermés.

Après l'arrêt

- Éteignez d'abord le récepteur, puis l'émetteur. Cela empêchera une éventuelle perte de contrôle du véhicule.

Sécurité de la batterie

- Faites très attention lorsque vous manipulez la batterie. Elle sera très chaude après utilisation. Si un câble était dénudé, un court-circuit pourrait provoquer un incendie.

Equipment Needed
Benötigtes Zubehör
Équipement nécessaire

Transmitter
Sender
Émetteur

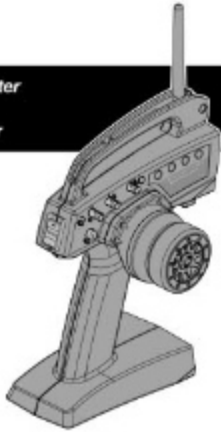

Steering Servo
Lenkservo
Servo de direction

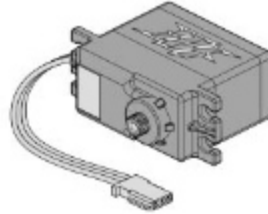

Receiver
Empfänger
Récepteur

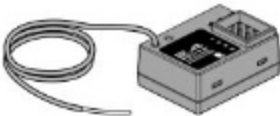

Electronic Speed Control (ESC)
Elektronischer Fahrtenregler (ESC)
Contrôleur de vitesse (ESC)

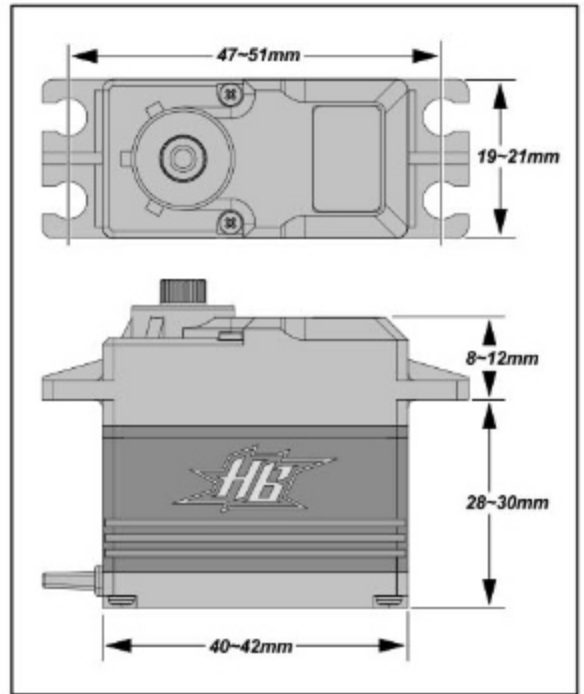
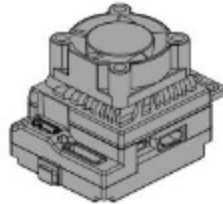

Batteries for transmitter
Senderbatterien
Piles de l'émetteur

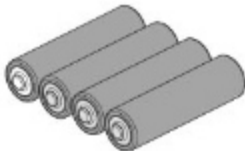

Charger
Ladegerät
Chargeur



Electric Motor
Elektromotor
Moteur électrique

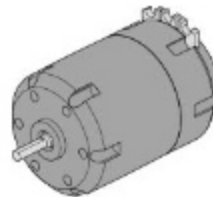

Body
Karosserie
Carrosserie

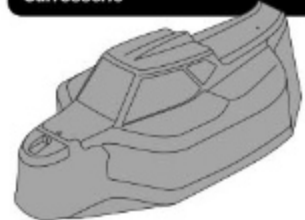

Wheels and Tires
Räder und Reifen
Roues et Pneus



Battery
Fahrakku
Batterie

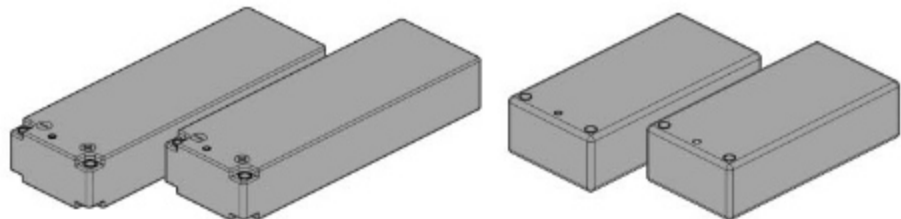

Accepts 4s 'brick' packs, 2 x 2s 'long' batteries, and 2 x 2s 'shorty' batteries (allows fore/aft weight adjustment).



Caution
Warnhinweise
Précautions

If you do not use a charger designed to charge Nickel Metal Hydride / LiPo batteries, the batteries will be damaged.
 Wenn Sie keinen geeigneten Lader zum Laden der Nickel-Metall-Hydrid oder LiPo Akkus verwenden, werden die Akkus beschädigt.
 Si vous n'utilisez pas un chargeur conçu pour recharger les batteries Nickel Métal Hydride ou LiPo, celles-ci seront endommagées.

Tools Werkzeuge Outils

Tools needed for assembly. Sold separately.
Zum Zusammenbau benötigtes Werkzeug. Separat erhältlich.
Outils nécessaires pour la mise en place, vendus séparément.

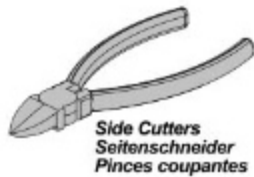

Side Cutters
Seitenschneider
Pincés coupantes

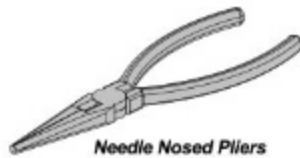

Needle Nosed Pliers
Flachzange
Pince à bec fin

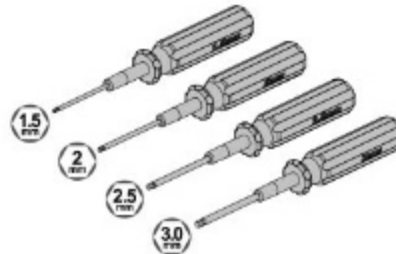

Allen Wrench 1.5mm / 2.0mm / 2.5mm / 3.0mm
Inbusschlüssel 1.5mm / 2.0mm / 2.5mm / 3.0mm
Clé Allen 1.5mm / 2.0mm / 2.5mm / 3.0mm

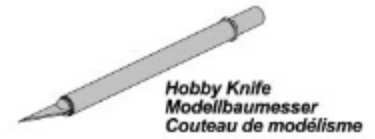

Hobby Knife
Modellbaumesser
Couteau de modélisme

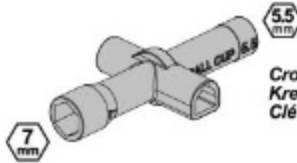

Cross Wrench
Kreuzschlüssel
Clé en croix

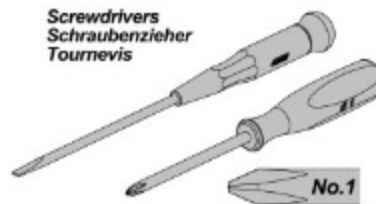

Screwdrivers
Schraubenzieher
Tournevis



Reamer
Karosserieloch-Bohrer
Alésoir



Turnbuckle Wrench
Spurstangenschlüssel
Clé à biellettes

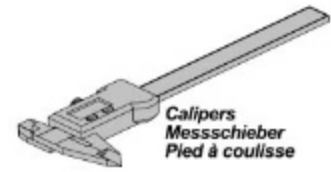

Calipers
Messschieber
Pied à coulisse

Thread Lock (Red)
Schraubensicherung (Rot)
Frein A Filet (Rouge)



Grease
Fett
Graisse



Instant Cement
Sekundenkleber
Colle rapide



Paint
Lexanfarbe
Peinture



Included Items Enthaltenes Werkzeug Éléments inclus



ORI44406
Silicone Oil #400
Silikon Daempferoel #400
Huile silicone 400



ORI44420
Silicone Oil #7,000
Silikon Daempferoel #7,000
Huile silicone 7,000



ORI44417
Silicone Oil #4000
Silikon Daempferoel #4000
Huile silicone 4000



ORI44415
Silicone Oil #2,000
Silikon Daempferoel #2,000
Huile silicone 2,000

Caution Achtung Attention



Do not run in water or sand.
Fahren Sie nie in Wasser oder Sand.
Ne faites pas fonctionner dans l'eau ou sur le sable.

Do not run on public streets or highways. This could cause serious accidents, personal injuries, and/or property damage.
Fahren Sie niemals auf öffentlichen Straßen. Dies kann zu schweren Unfällen mit Personen- und Sachschaden führen.
Ne faites pas fonctionner sur la voie publique ou la route. Cela pourrait provoquer des accidents graves, des blessures corporelles ou des dommages aux biens.

STEP A-01

UPDATES

Check www.hbracing.com for the latest updates to the instructions.

Front
Vorne
Avant

2x Make 2
2 Stück

Rear
Hinten
Arrière

2x Make 2
2 Stück

Front Shock Set 204341
Rear Shock Set 204342

SETUP SHEET

See Set-Up Sheet on Page 33 or hbracing.com

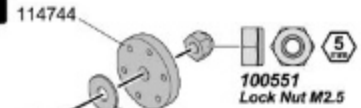

Front 109631
Rear 204457

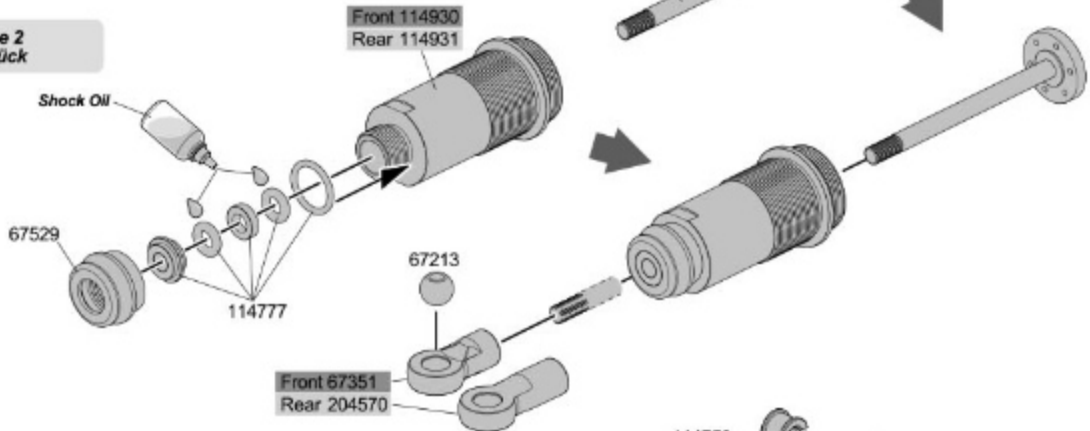

Move the shaft up and down slowly to remove all air bubbles.
Bewegen Sie die Kolbenstange langsam nach oben und unten, damit Luftblasen entweichen können.
Déplacez l'axe vers le haut et vers le bas doucement pour faire partir toutes les bulles.

ORI44406
Silicone Oil #400
Silikon Dämpferöl #400
Huile silicone 400

SETUP SHEET

See Set-Up Sheet on Page 33 or hbracing.com

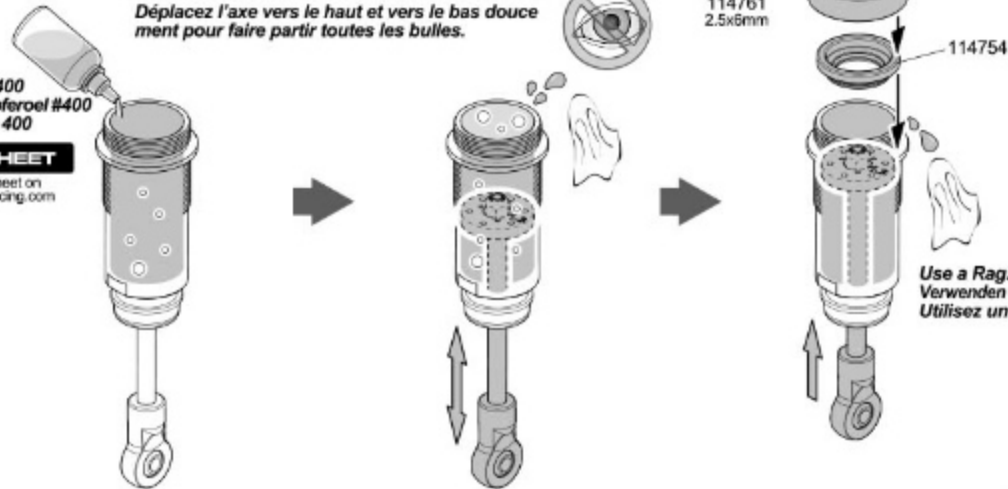

Use a Rag.
Verwenden Sie einen Putzlappen.
Utilisez un chiffon.

Front 109832
Rear 109834

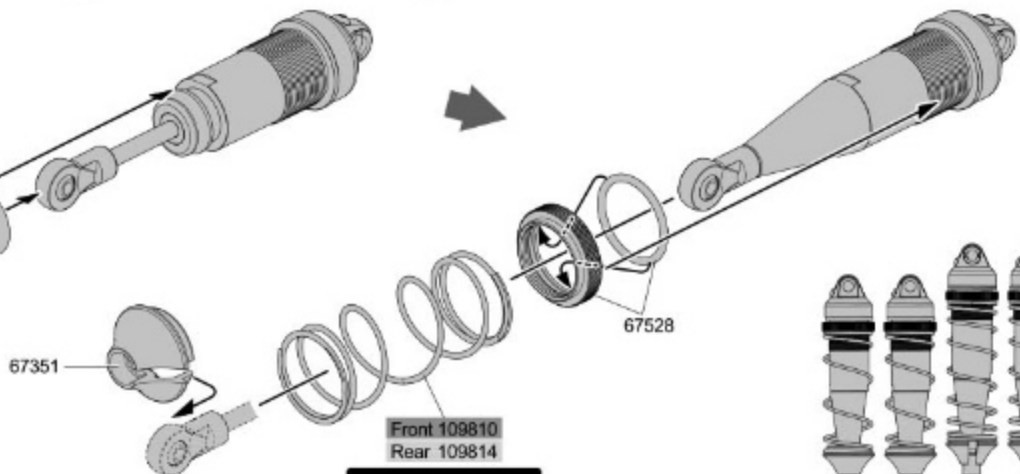

SETUP SHEET

See Set-Up Sheet on Page 33 or hbracing.com

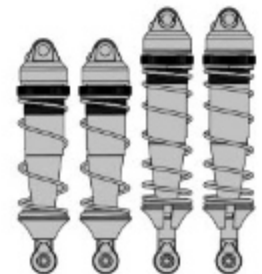

STEP B-01 & 02

Front
Vorne
Avant

1x Make 1
1 Stück 1 fois

Rear
Hinten
Arrière

1x Make 1
1 Stück 1 fois

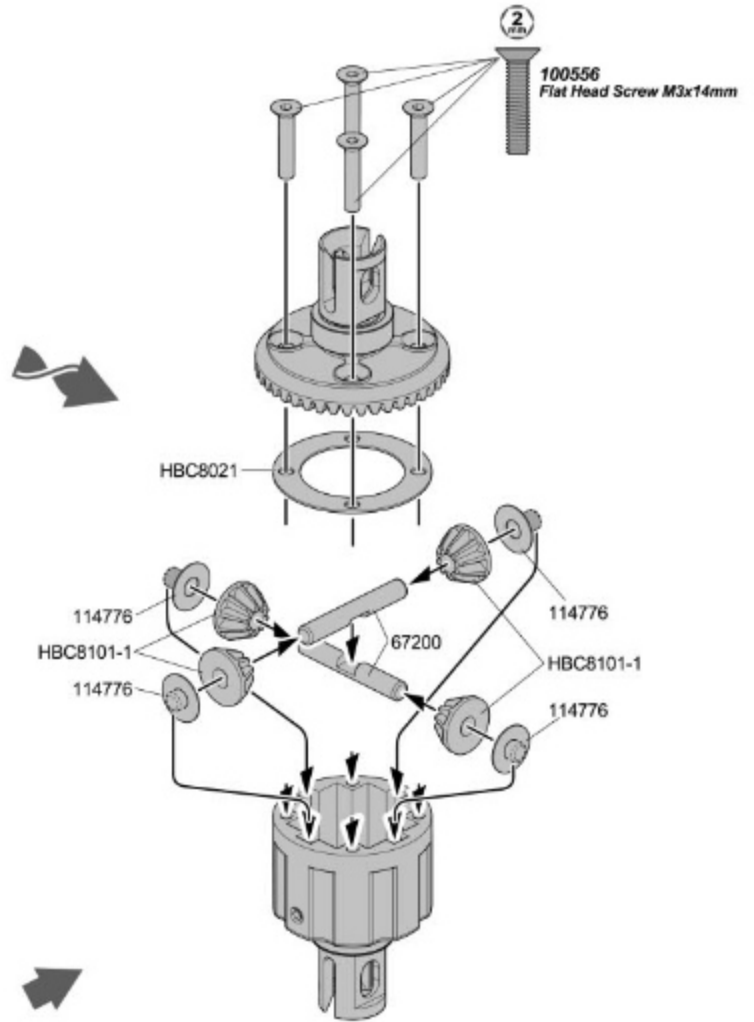
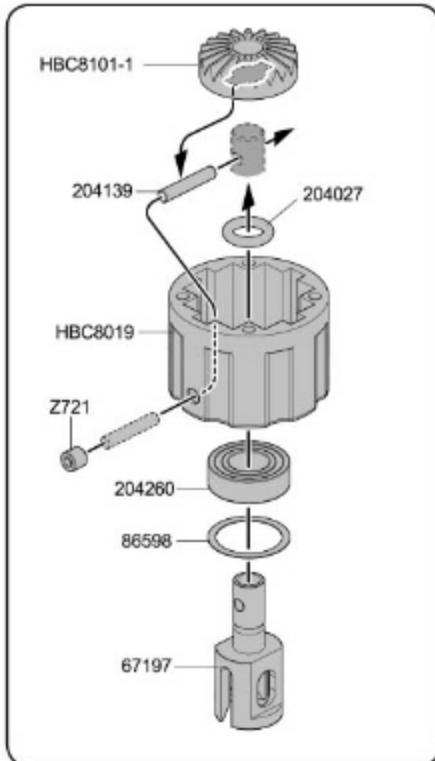
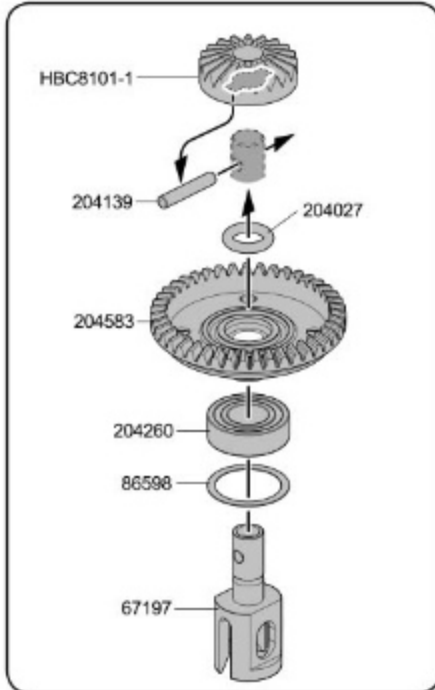

SETUP SHEET

See Set-Up Sheet on
Page 33 or hbracing.com



#7,000

Front
Vorne
Avant

ORI44420
Silicone Oil #7,000
Silikon Daempferoel #7,000
Huile silicone 7,000

#2,000

Rear
Hinten
Arrière

ORI44415
Silicone Oil #2,000
Silikon Daempferoel #2,000
Huile silicone 2,000

Fill to top of cross shafts with silicone diff oil.
Füllen Sie das Gehäuse bis zum Wellenkreuz
mit Silikon-Differential-Öl.

Remplissez d'huile jusqu'en haut des arbres trans-
versaux avec de l'huile silicone pour différentiel.

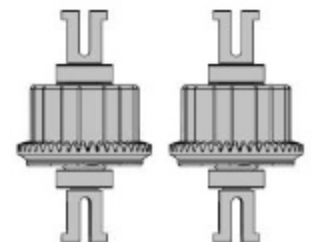

Step Complete

STEP B-03

! Center
Mitte
central

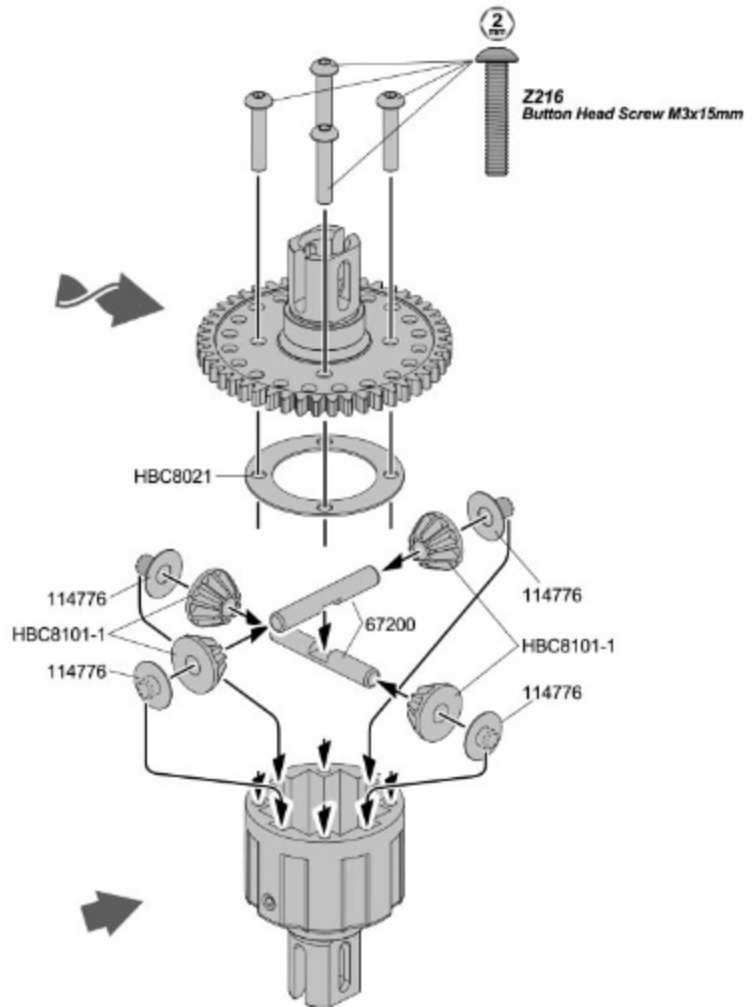
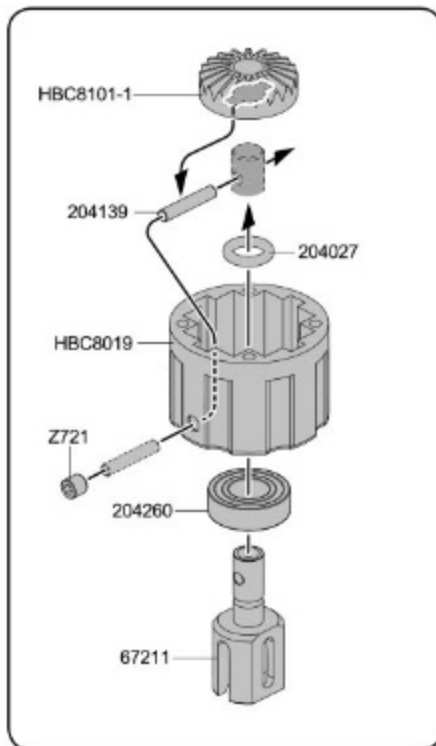
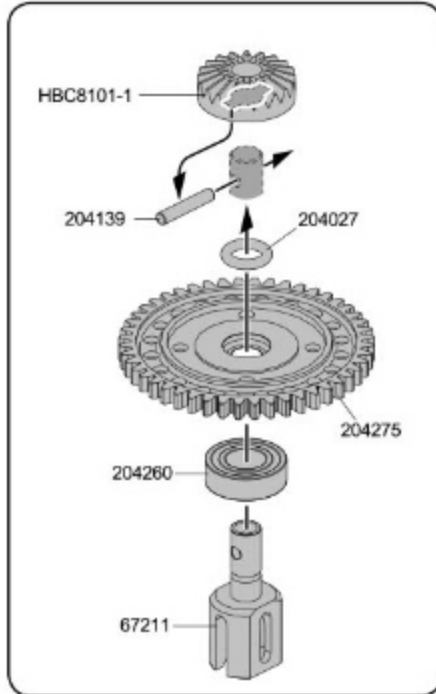

SETUP SHEET

See Set-Up Sheet on
Page 33 or hbracing.com

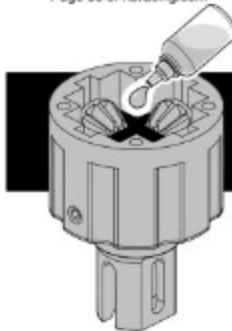

#4,000

ORI44417
Silicone Oil #4,000
Silikon Daempferöl #4,000
Huile silicone 4,000

Fill to top of cross shafts with silicone diff oil.
Füllen Sie das Gehäuse bis zum Wellenkreuz
mit Silikon-Differential-Öl.
Remplissez d'huile jusqu'en haut des arbres trans
versaux avec de l'huile silicone pour différentiel.

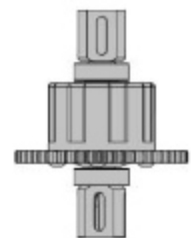

Step Complete

STEP C-01

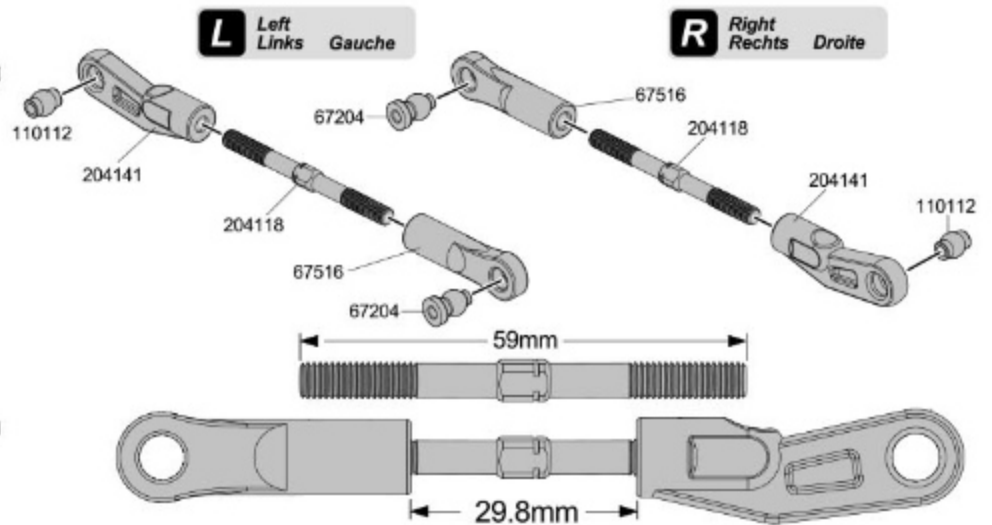
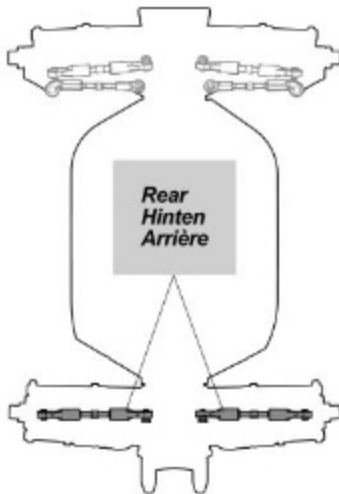
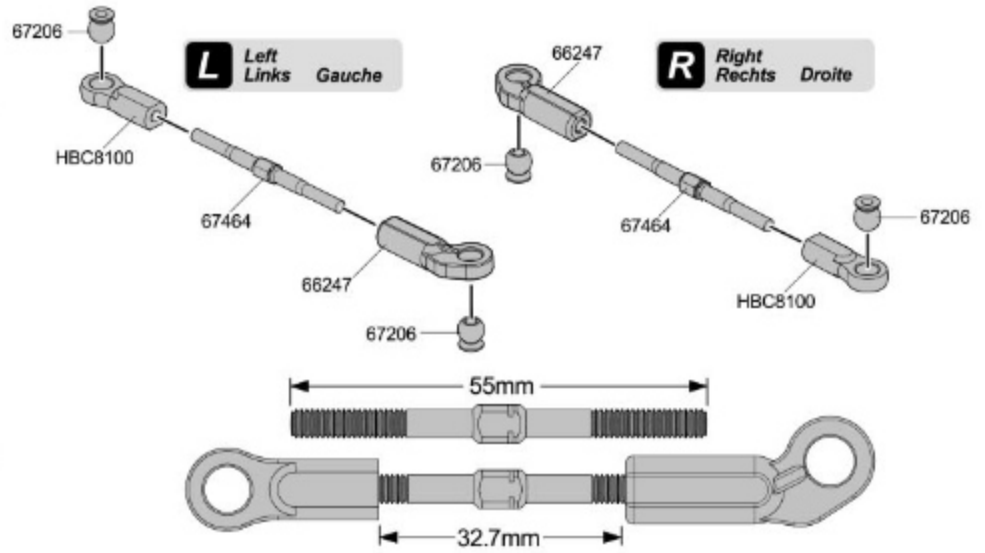
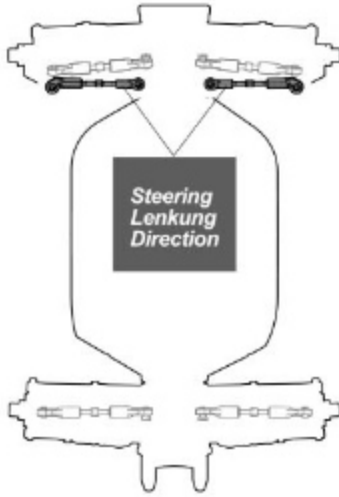
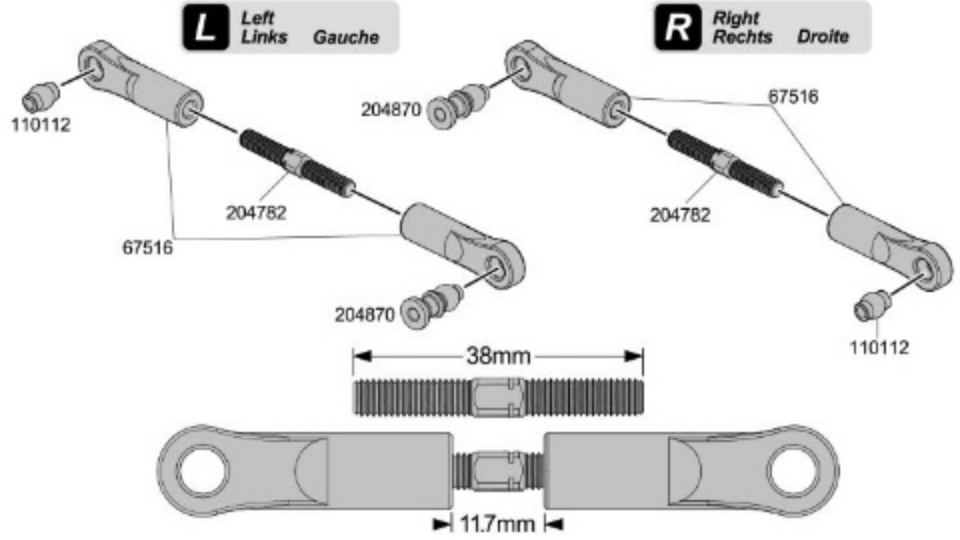
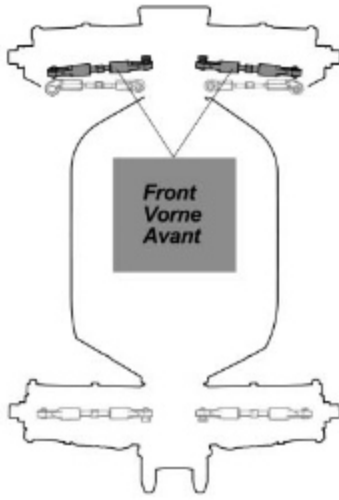

BAG-D

STEP D-01

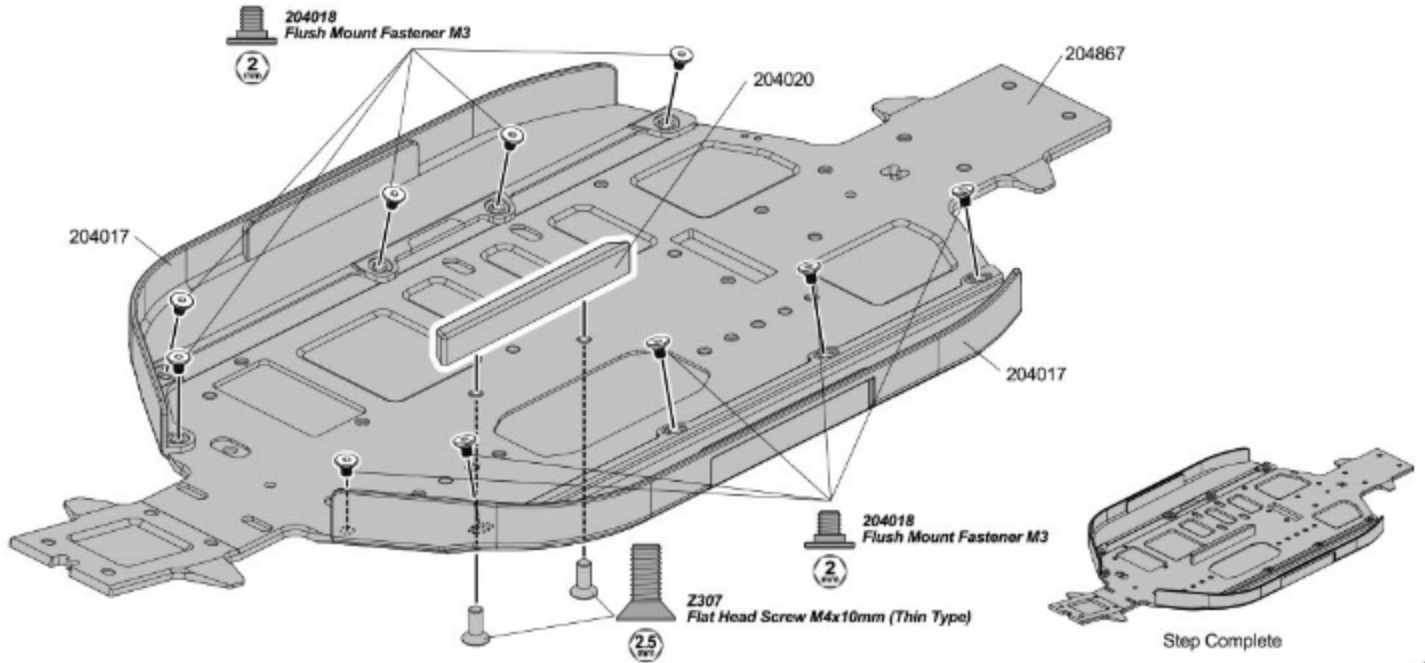

BAG-E

STEP E-01

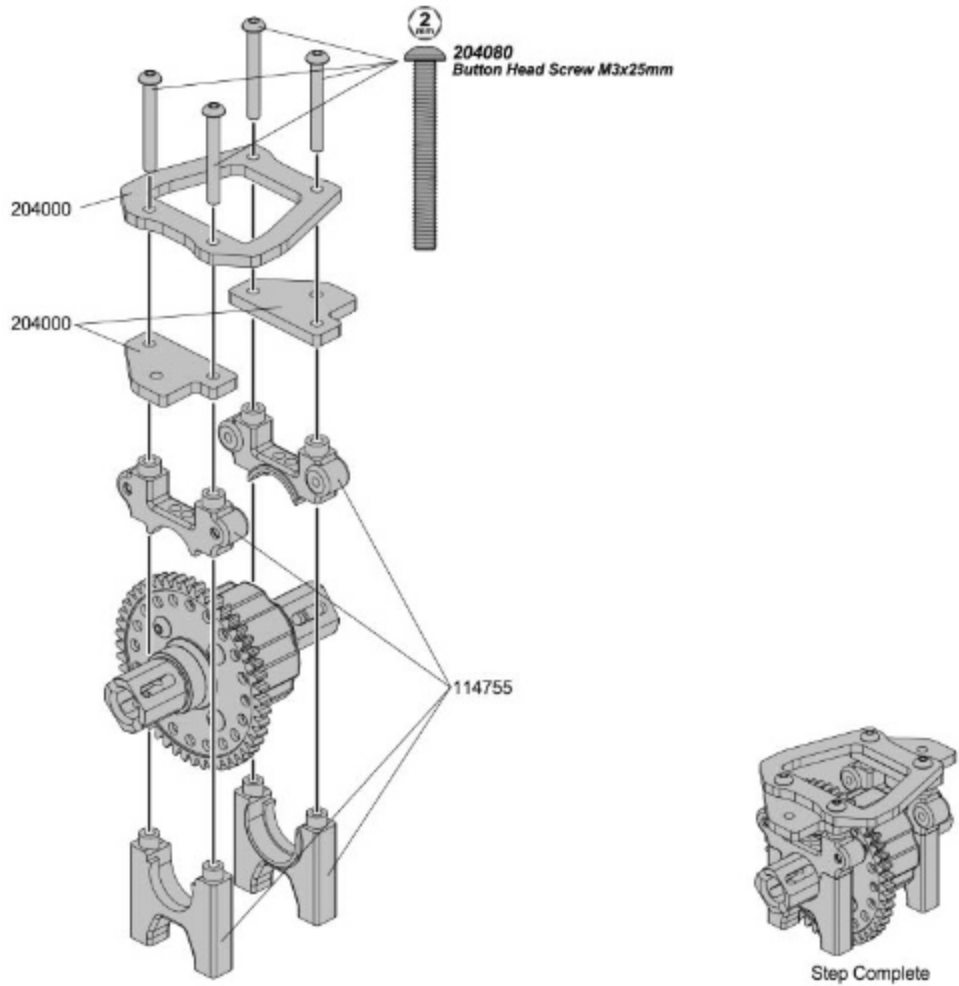

BAG - E

STEP E-02

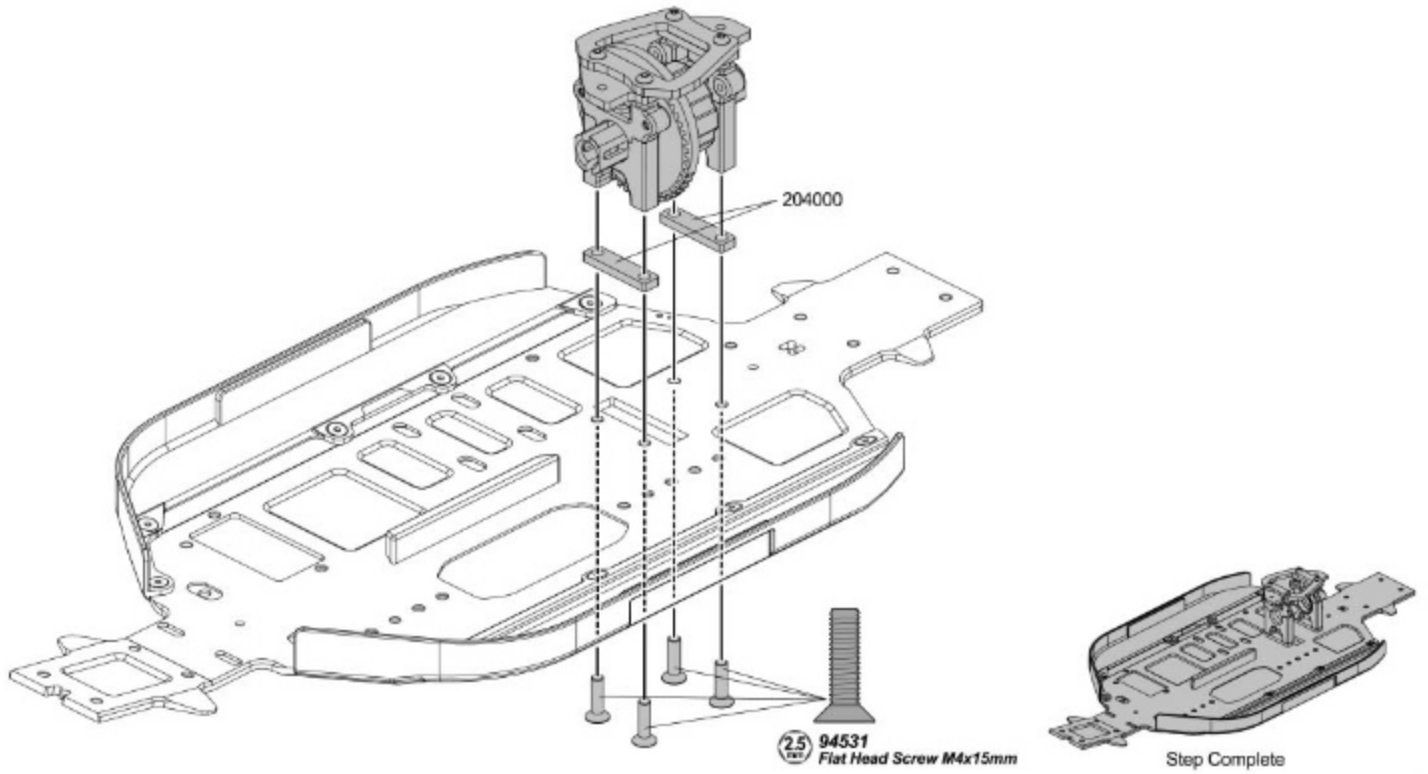

BAG - F

STEP F-01

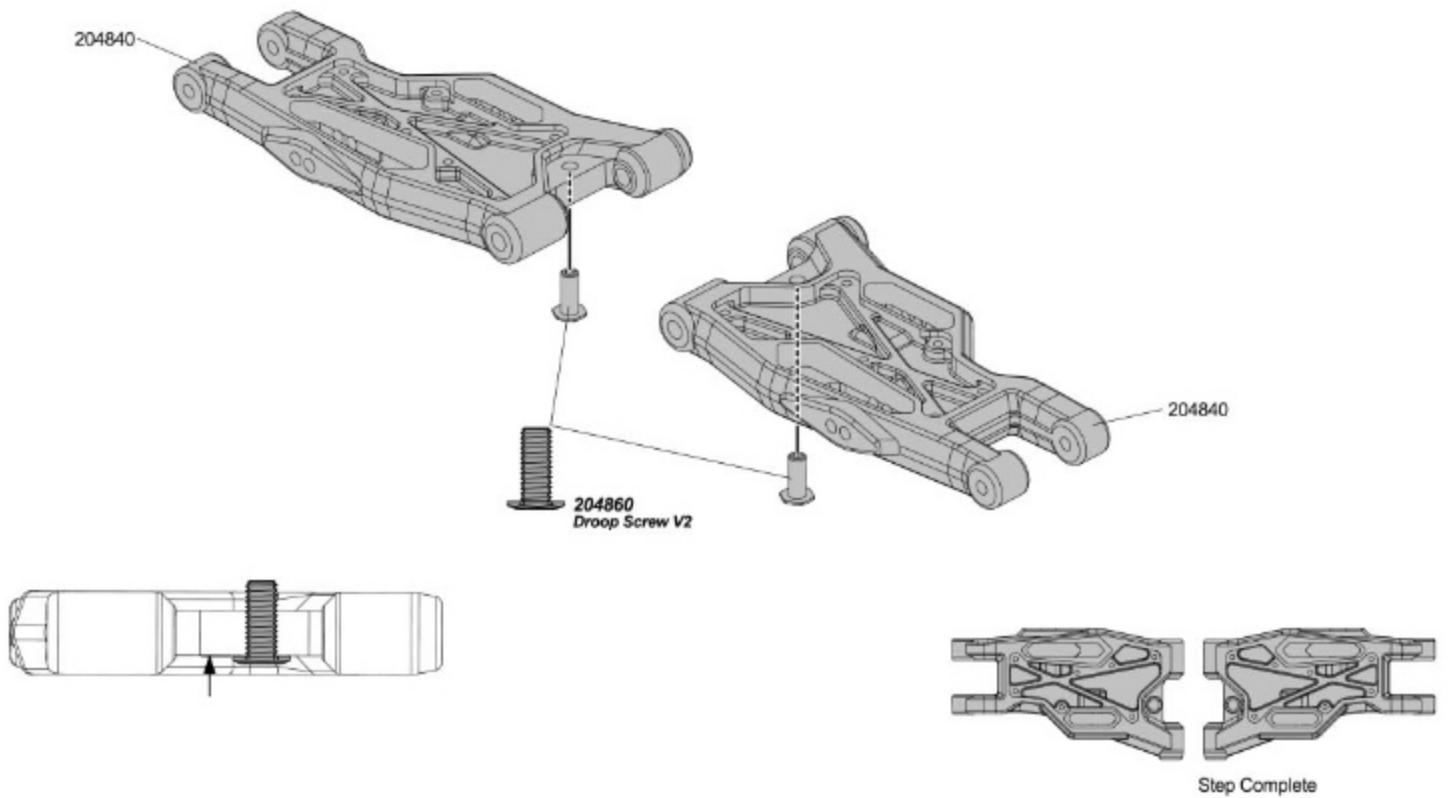

STEP F-02

2x Make 2
2 Stück 2 fois

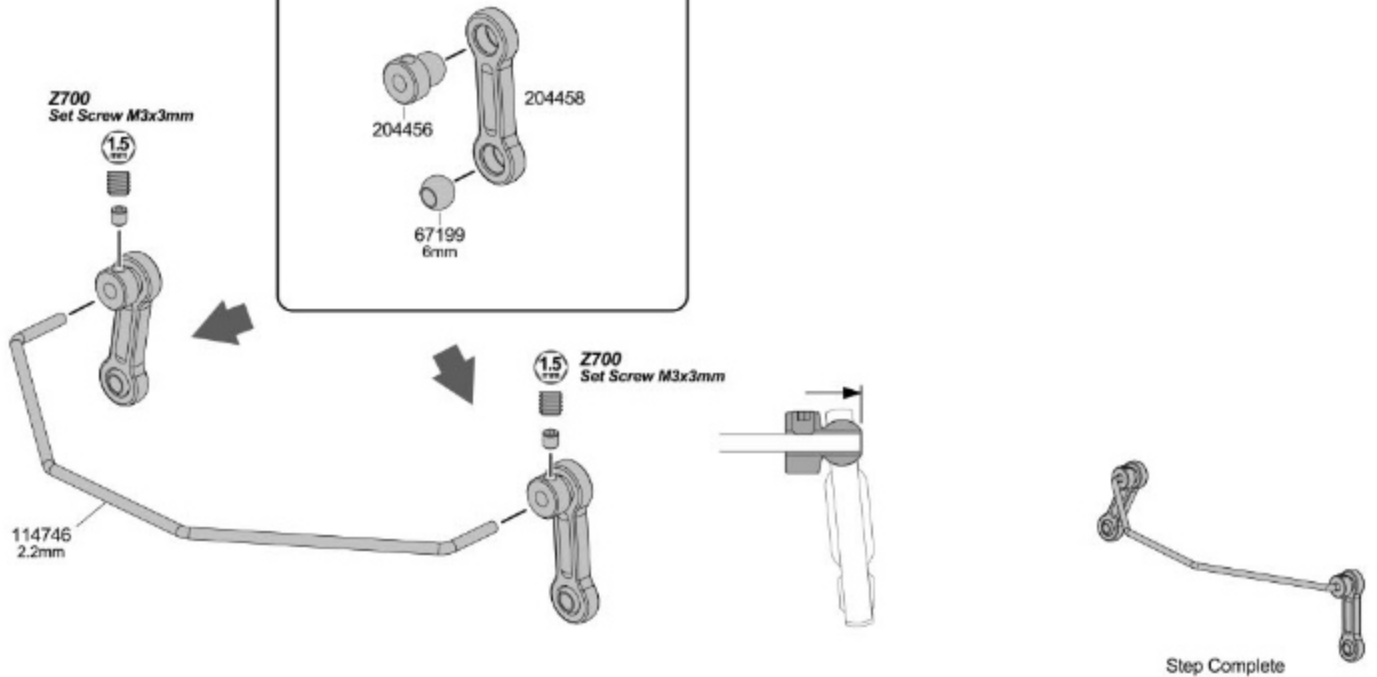

Visit

www.HBRACING.com

- Latest set-up sheets
- Instruction updates
- Newest option parts
- Team info
- Race news



STEP F-03



B033
Ball Bearing 12x18x4mm

B034
Ball Bearing 12x21x5mm

B023
Ball Bearing 6x13x5mm

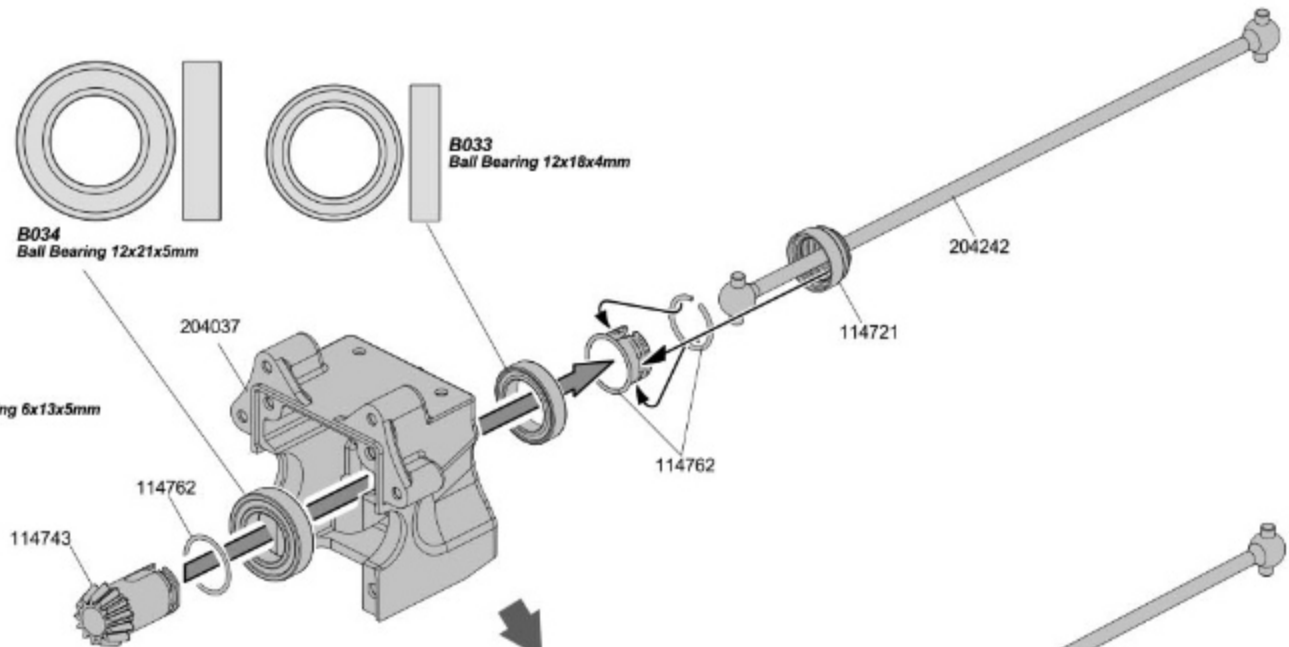

Z544
Cap Head Screw M3x12mm

! Note direction of differential

Pay attention to the direction of the diff. If your motor turns in the standard direction (counterclockwise when looking at the pinion) install the diffs as shown.

If your ESC/motor combination allows you to reverse the rotation to clockwise you can install diffs the same way as the nitro car and not inadvertently install them the wrong way like when you're in a hurry or tired or distracted, etc.

Z354
Button Head Screw M3x12mm



100556
Flat Head Screw M3x14mm

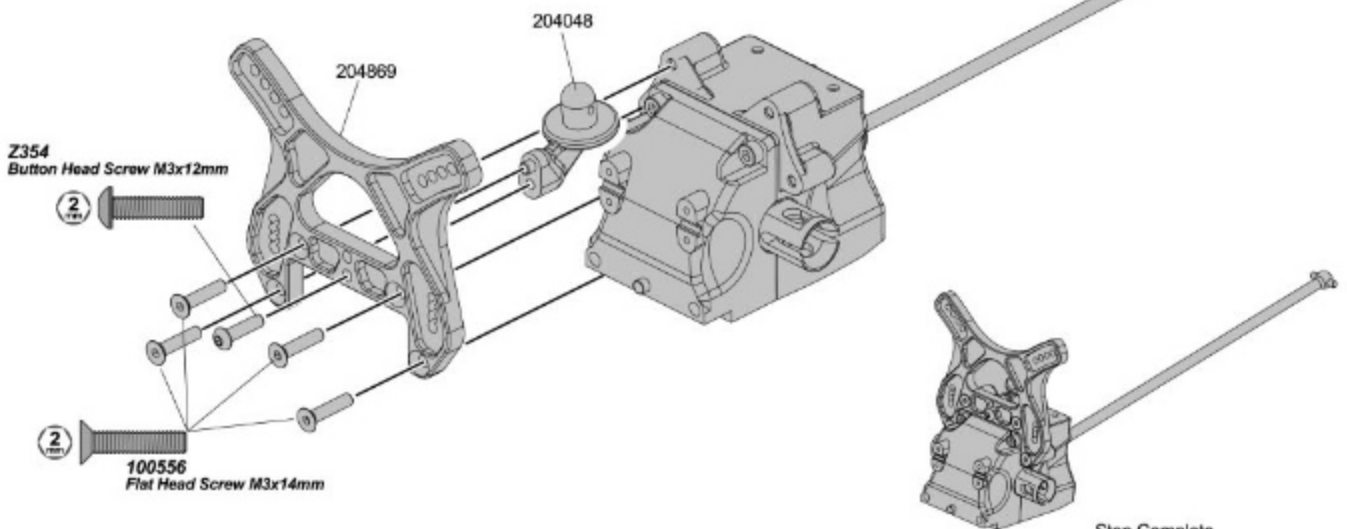

Step Complete

STEP F-04

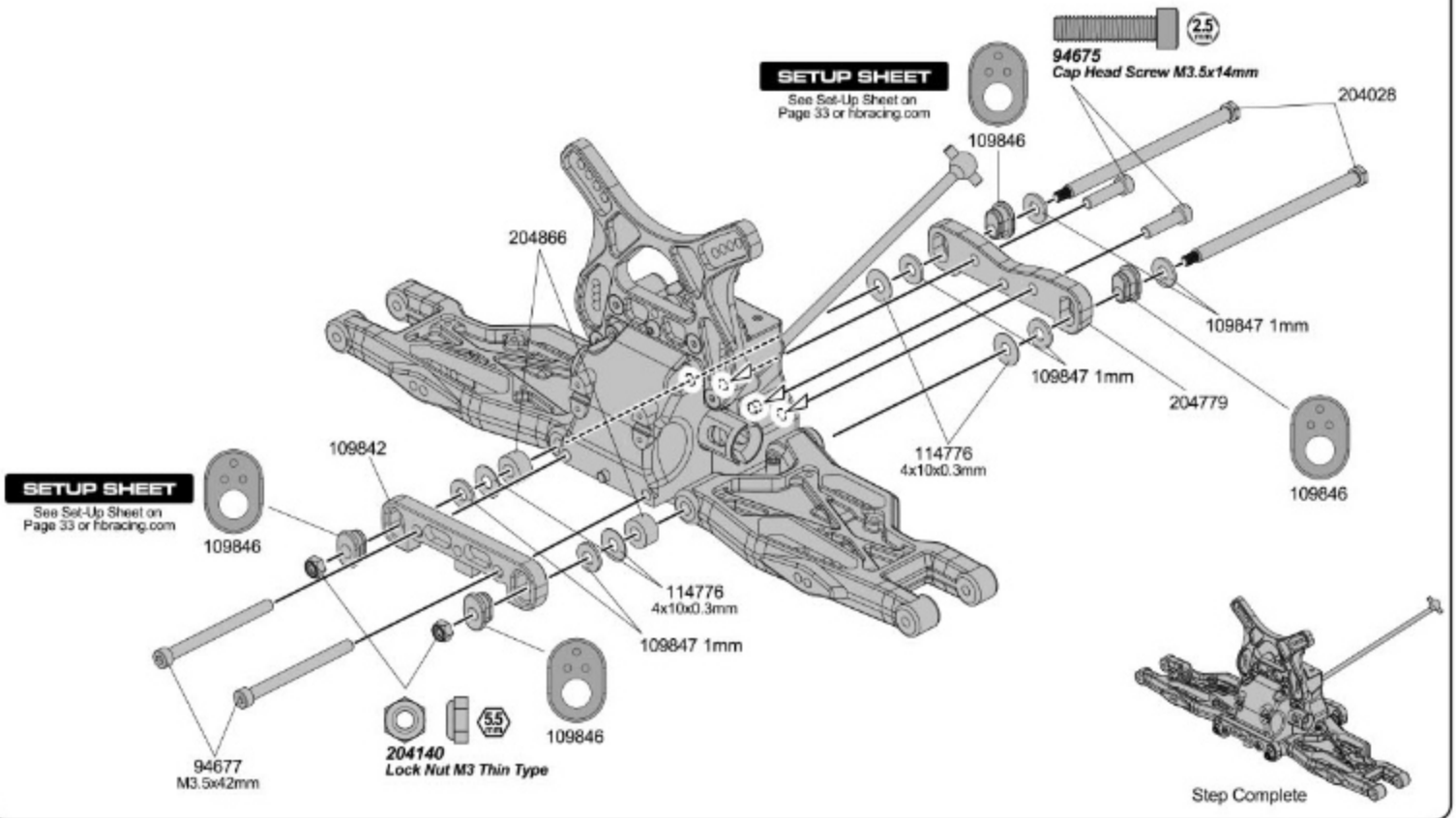

STEP F-05

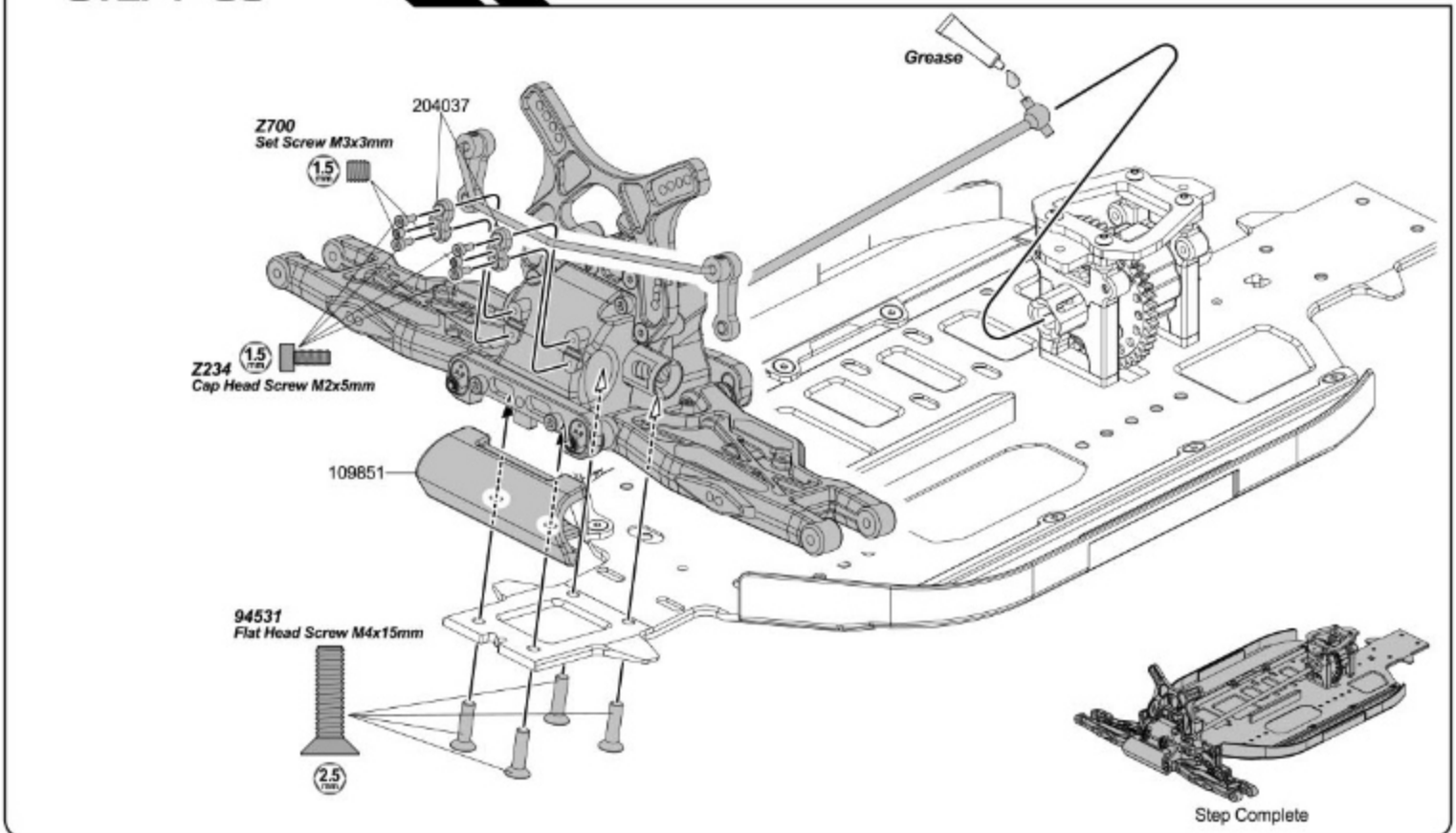

STEP F-06

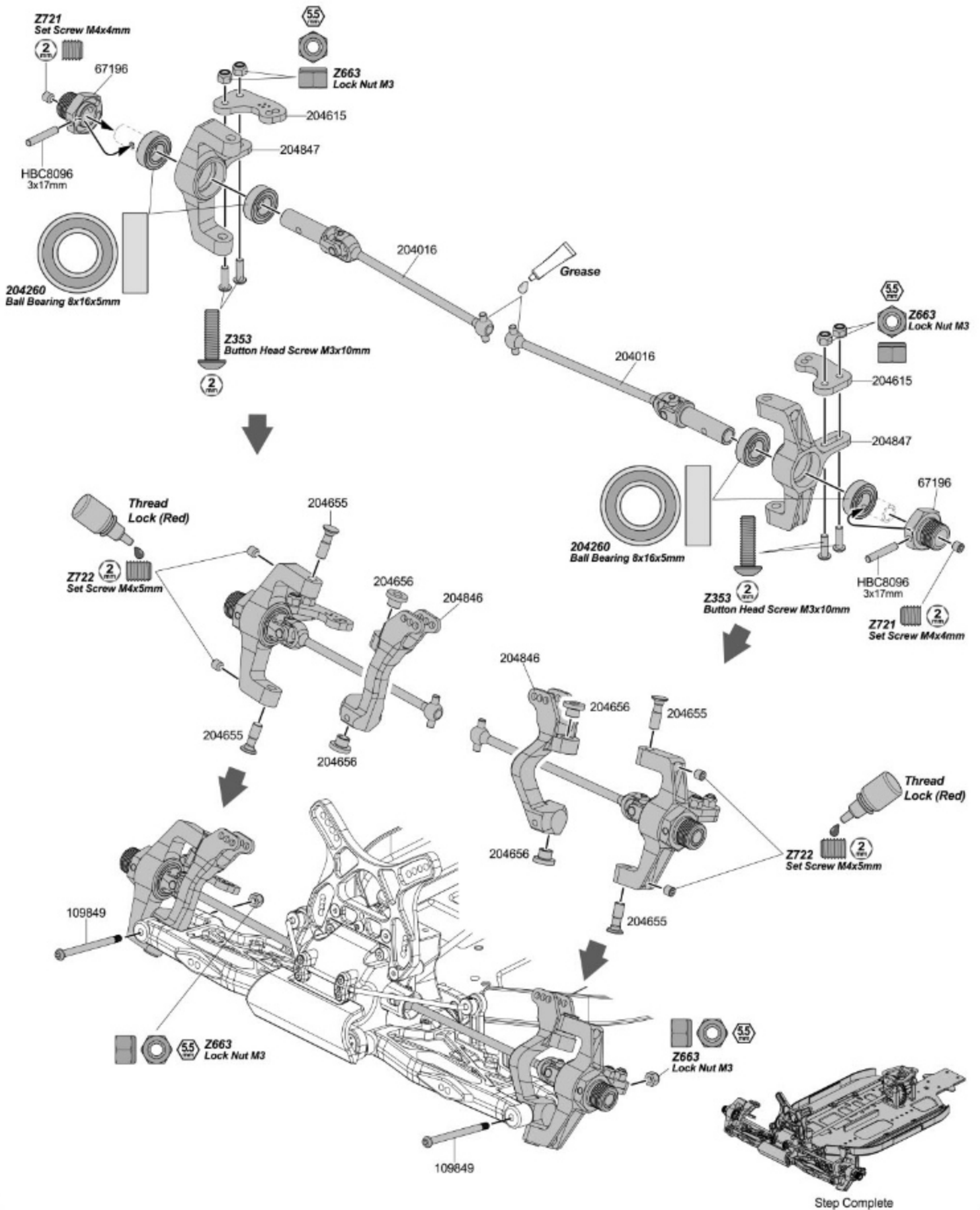

STEP F-07-1

SETUP SHEET

See Set-Up Sheet on
Page 33 or hbracing.com

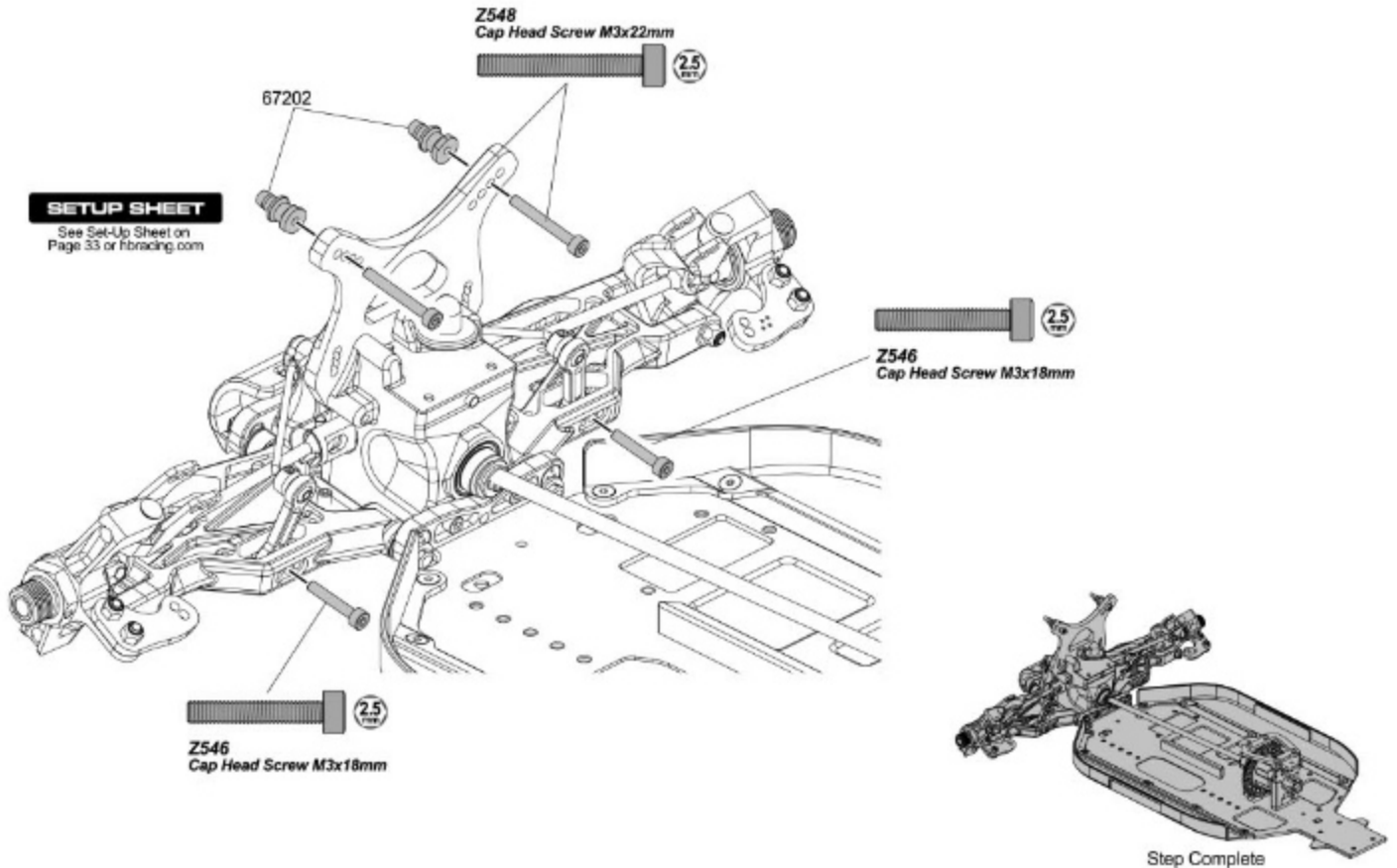

STEP F-07-2

SETUP SHEET

See Set-Up Sheet on
Page 33 or hbracing.com

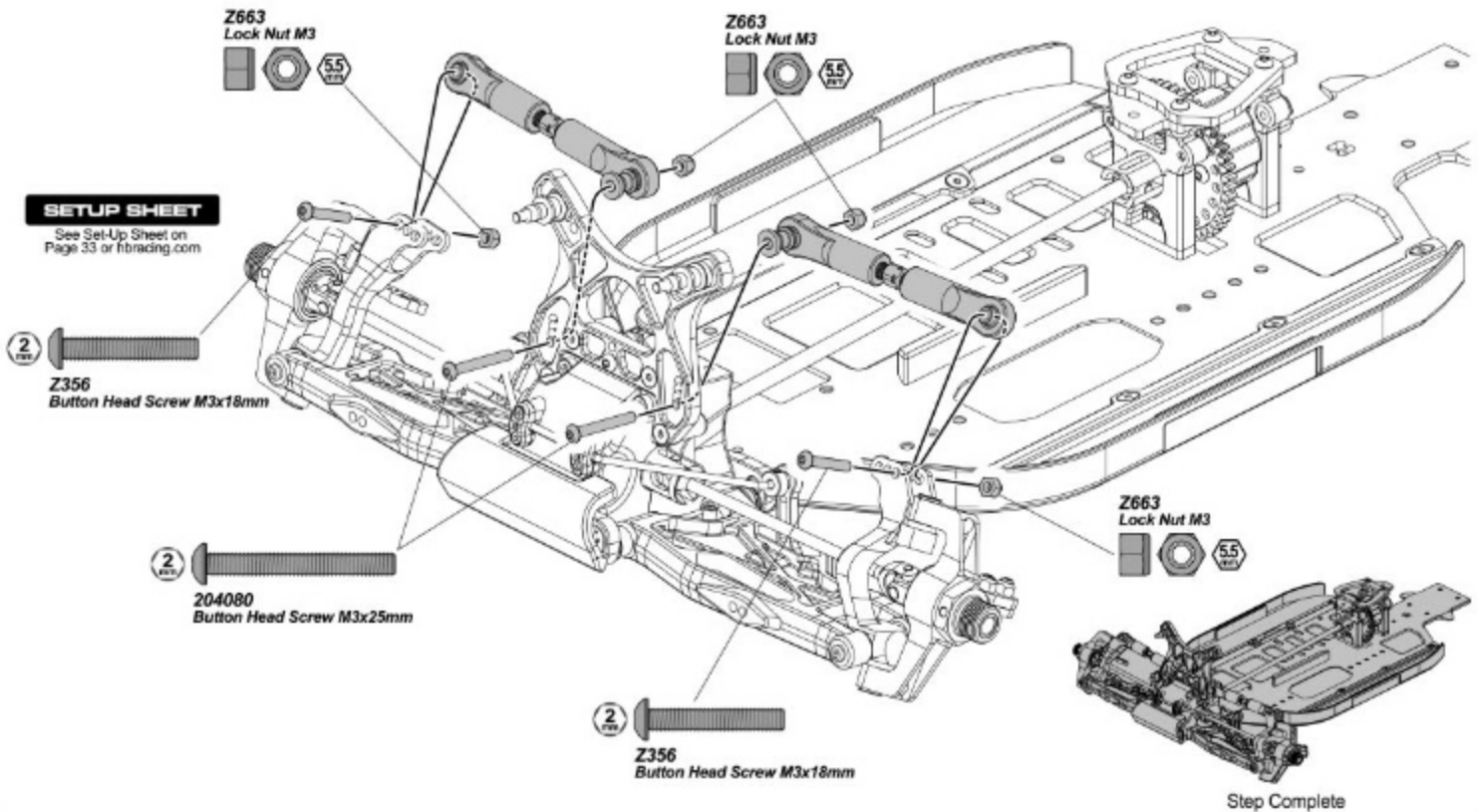

STEP G-01

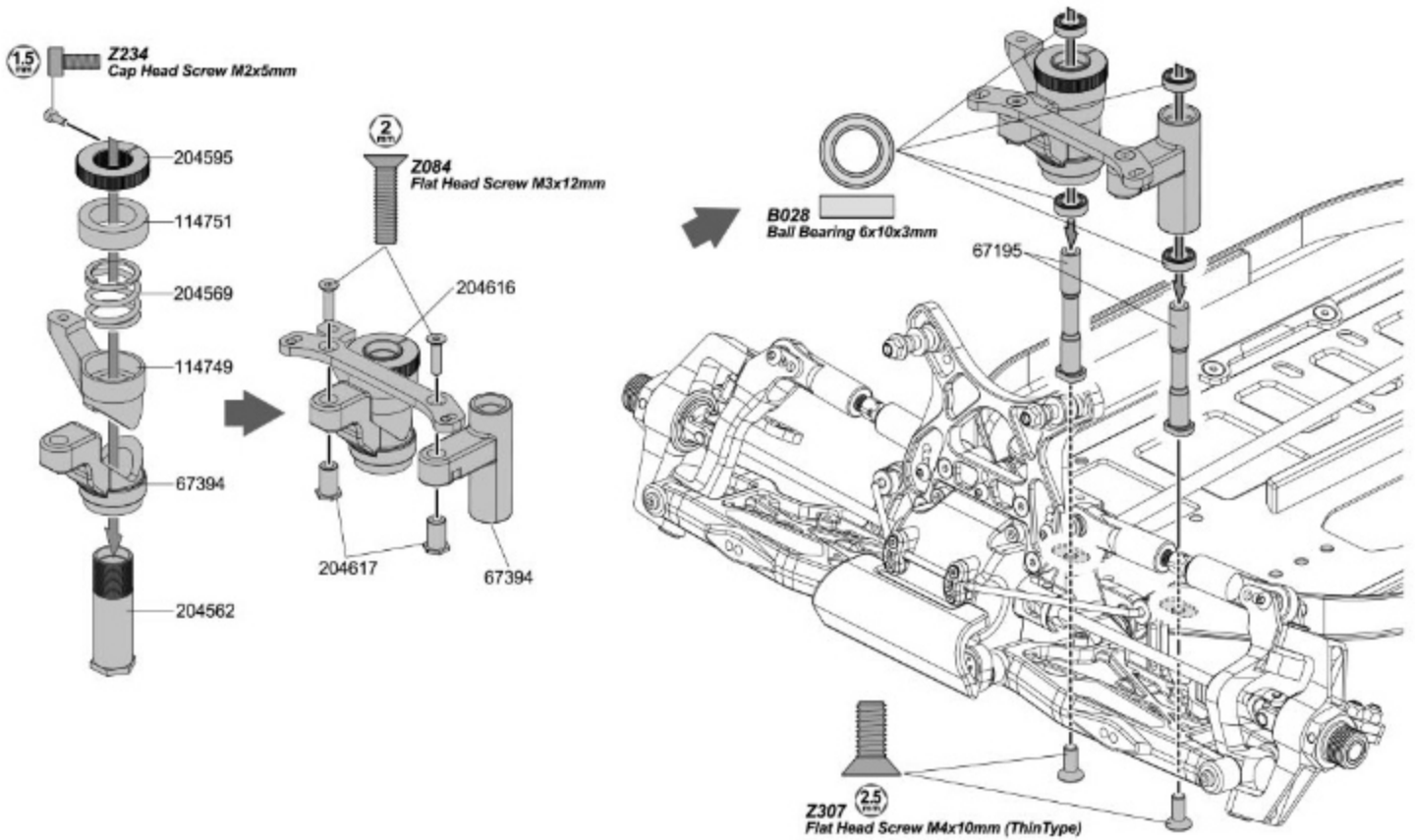

STEP G-02

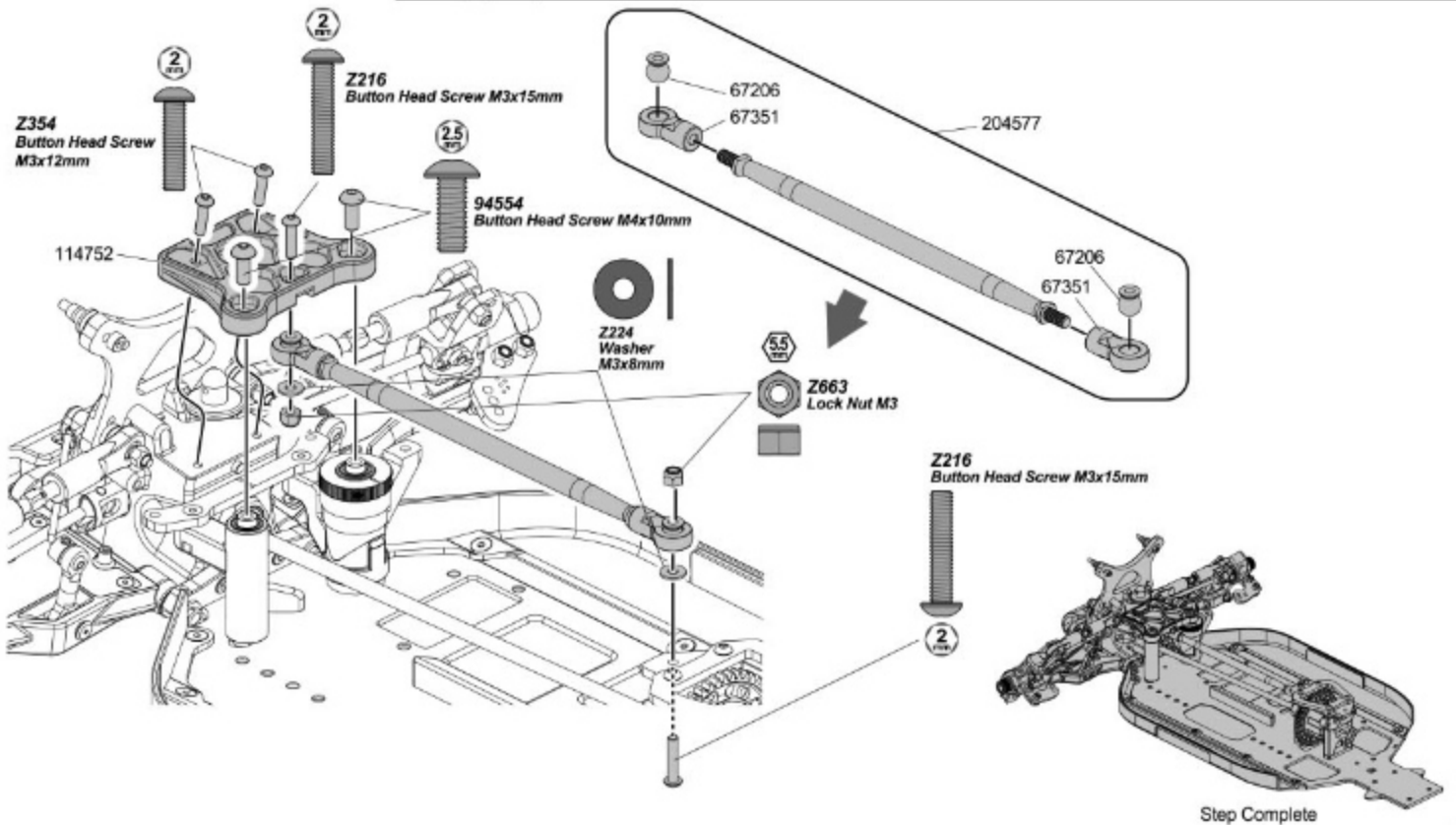

STEP G-03

SETUP SHEET

See Set-Up Sheet on
Page 33 or hbracing.com



2

Z087
Flat Head Screw M3x20mm

204871
2mm

204871
2mm

204871
2mm

2

Z087
Flat Head Screw M3x20mm

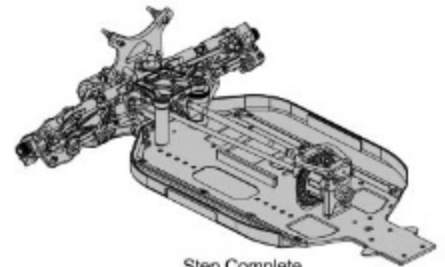

Step Complete

www.HBRACING.com

HBR WORLD SPEC

WORLD SPEC 1/8 SCALE 4WD ELECTRIC BUGGY

STEP H-01

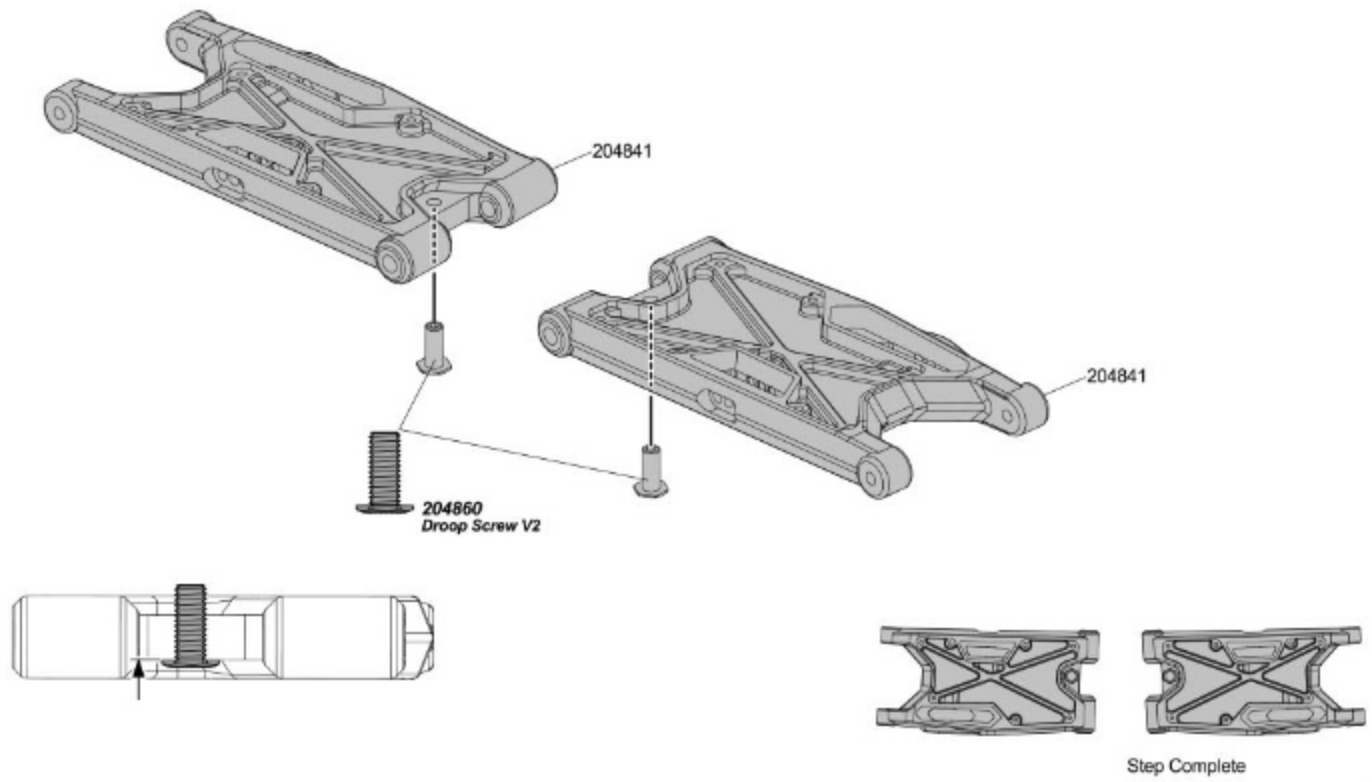

STEP H-02

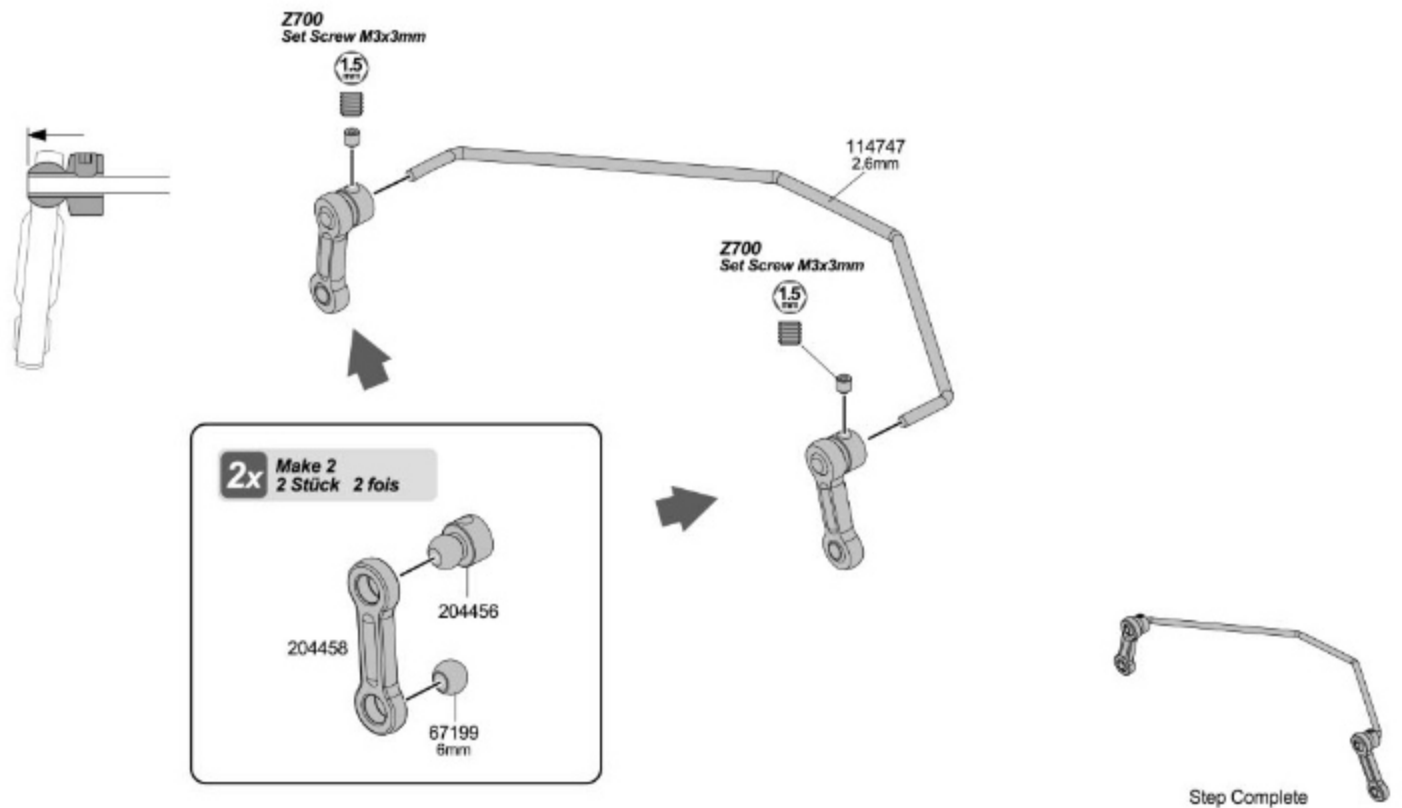

STEP H-03

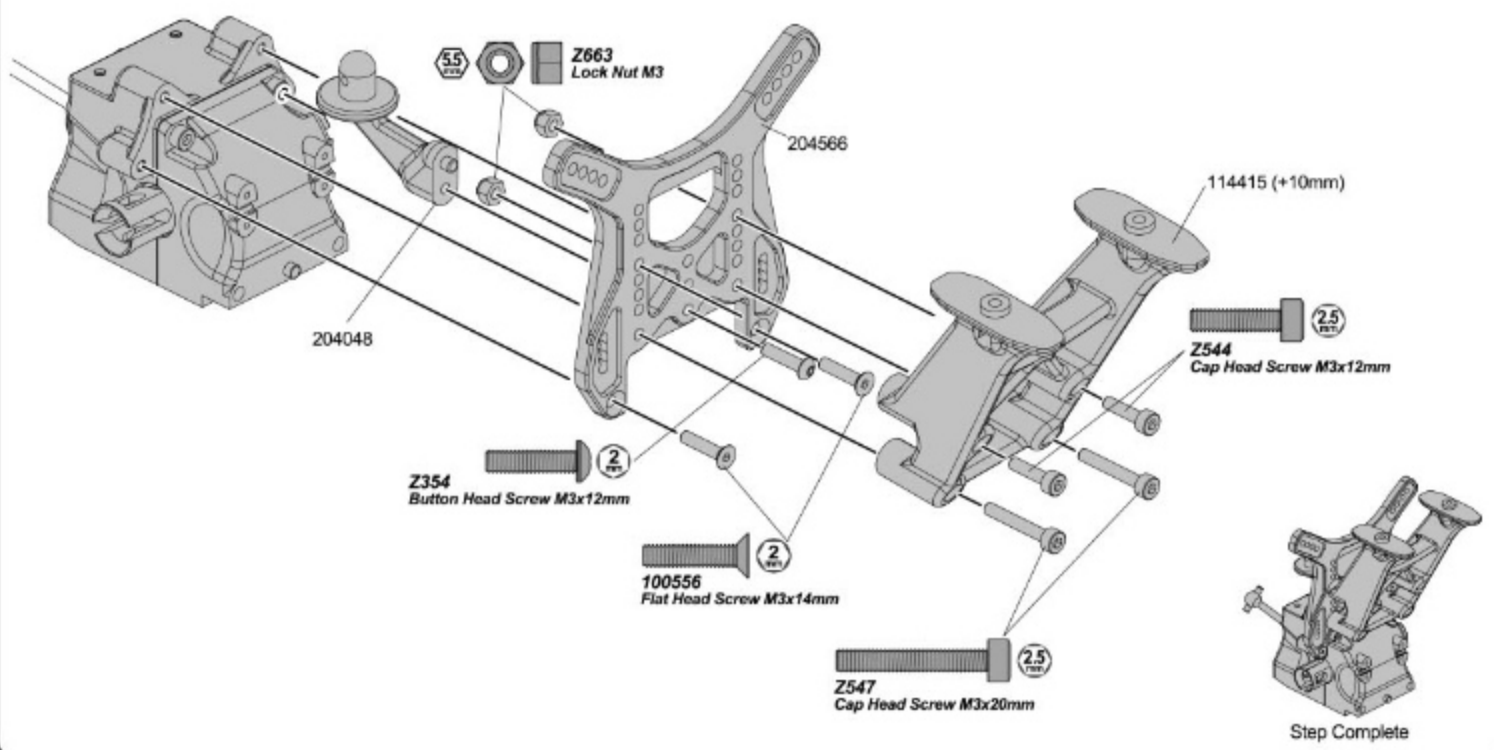
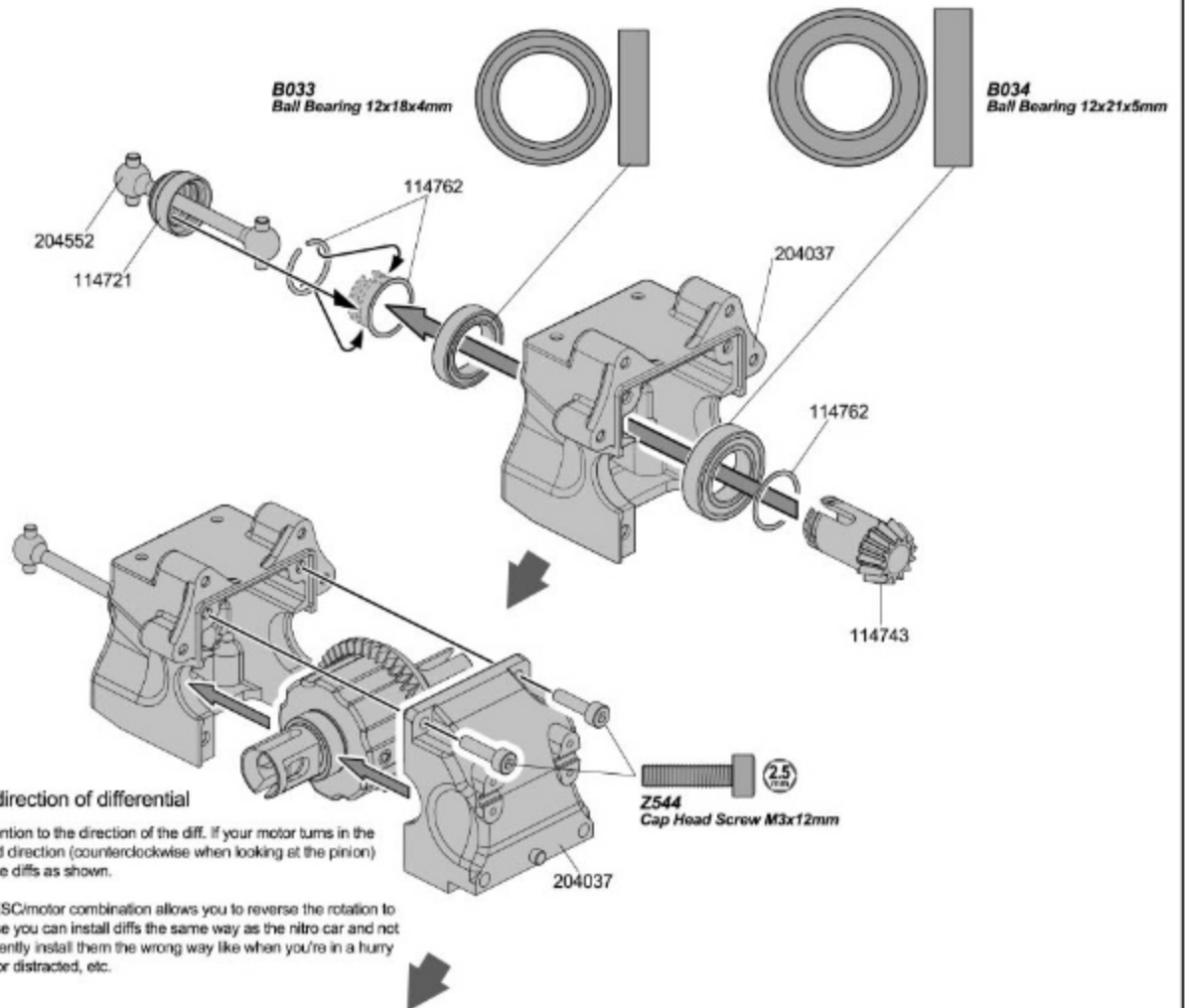

STEP H-04

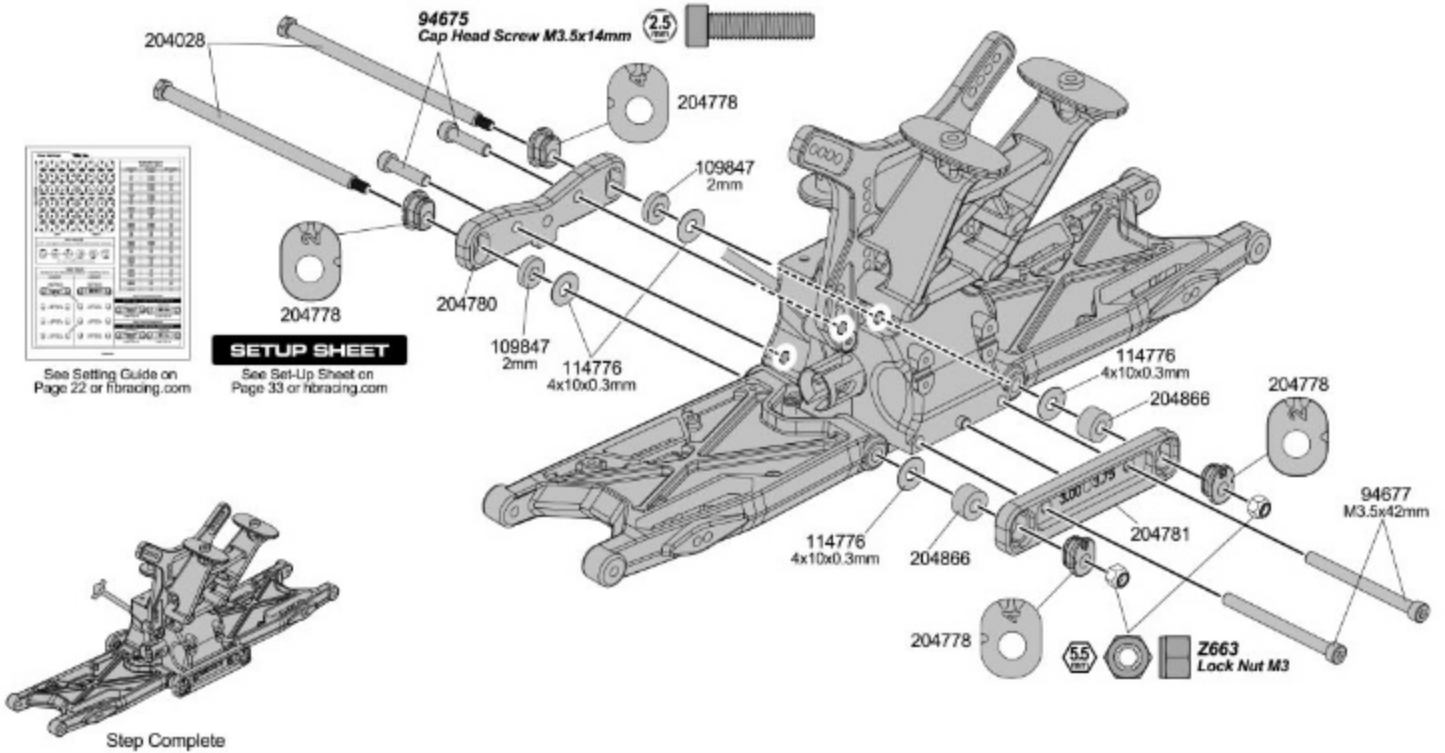

STEP H-05

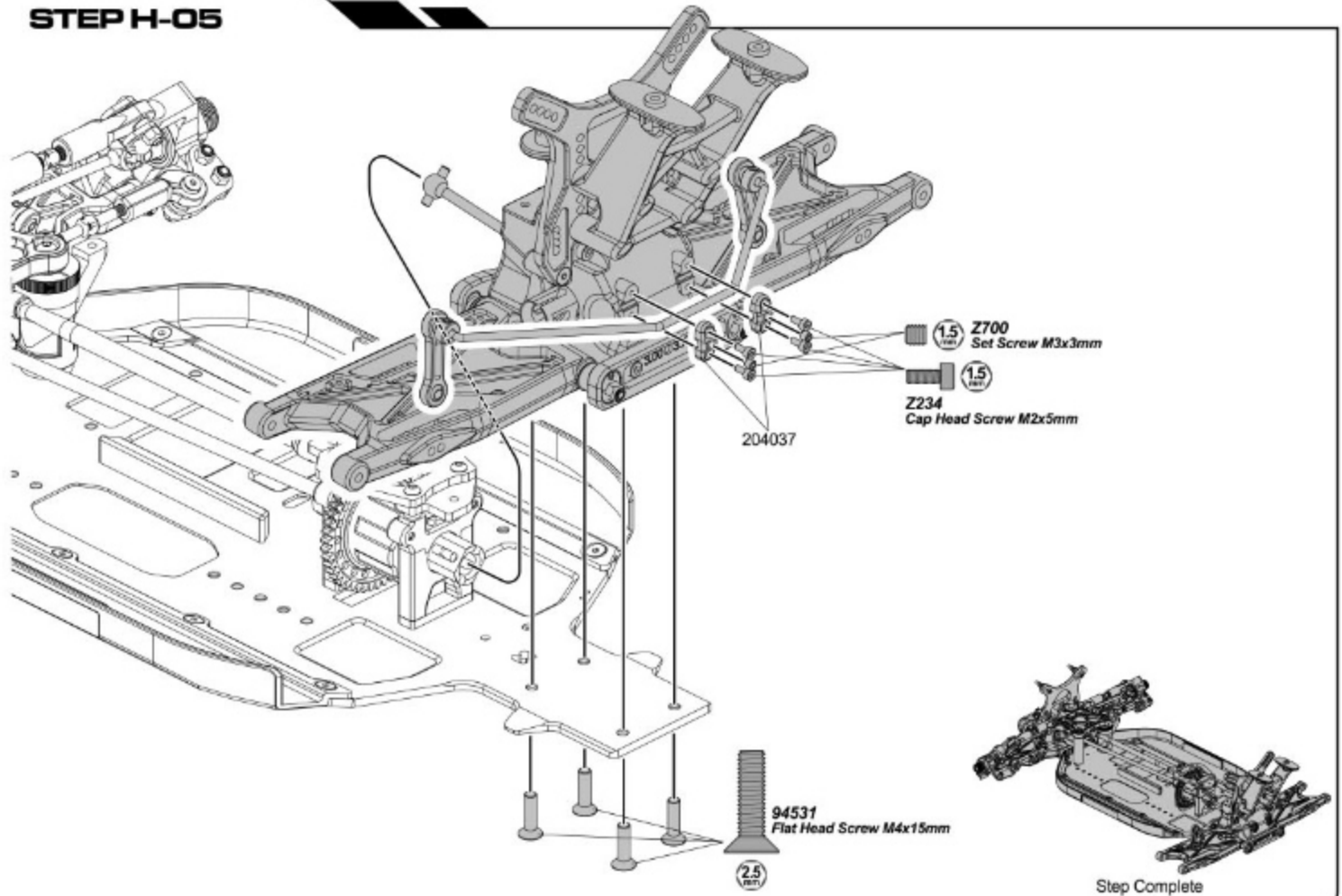

Rear Settings

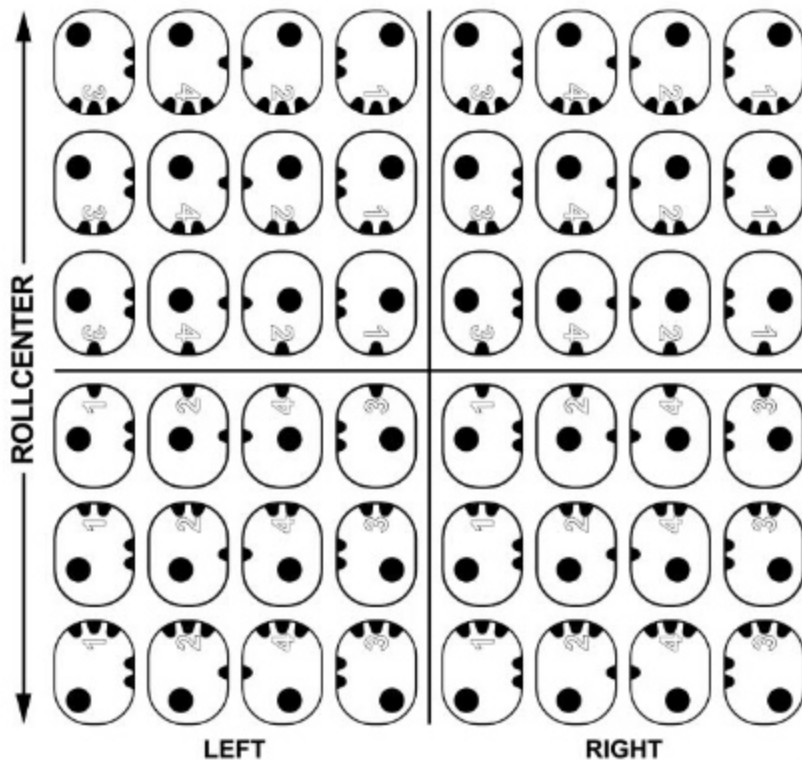

ROLLCENTER
3 UP is the highest rollcenter, 3 DOWN is the lowest rollcenter.



(The "1,2,3,4" numbers are only for inventory)

REAR TOE-IN

The sum of the C-Mount and D-Mount = Total Rear Toe-In.

C-MOUNT	D-MOUNT
2 NOTCHES OUT $+0.00^\circ$ TOE-IN 	2 NOTCHES OUT 3.00° TOE-IN
1 NOTCH OUT -0.25° TOE-IN 	1 NOTCH OUT 3.25° TOE-IN
1 NOTCH IN -0.50° TOE-IN 	1 NOTCH IN 3.50° TOE-IN
2 NOTCHES IN -0.75° TOE-IN 	2 NOTCHES IN 3.75° TOE-IN

Rear Toe-In Example #1

$$-0.00^\circ + 3.25^\circ = 3.25^\circ \text{ TOTAL REAR TOE-IN}$$

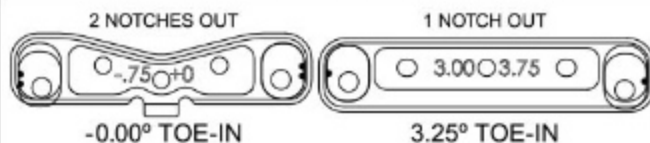

Rear Toe-In Example #2

$$-0.75^\circ + 3.50^\circ = 2.75^\circ \text{ TOTAL REAR TOE-IN}$$

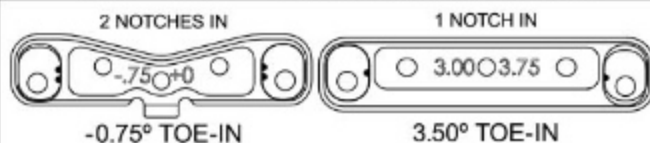

REAR ANTI-SQUAT (SORTED BY ANGLE)

C-MOUNT	D-MOUNT	ANTI-SQUAT
3 UP	3 DOWN	-0.5°
2 UP	3 DOWN	0.0°
3 UP	2 DOWN	0.0°
1 UP	3 DOWN	0.5°
2 UP	2 DOWN	0.5°
3 UP	1 DOWN	0.5°
1 DOWN	3 DOWN	1.0°
1 UP	2 DOWN	1.0°
2 UP	1 DOWN	1.0°
3 UP	1 UP	1.0°
2 DOWN	3 DOWN	1.5°
1 DOWN	2 DOWN	1.5°
1 UP	1 DOWN	1.5°
2 UP	1 UP	1.5°
3 UP	2 UP	1.5°
3 DOWN	3 DOWN	2.0°
2 DOWN	2 DOWN	2.0°
1 DOWN	1 DOWN	2.0°
1 UP	1 UP	2.0°
2 UP	2 UP	2.0°
3 UP	3 UP	2.0°
3 DOWN	2 DOWN	2.5°
2 DOWN	1 DOWN	2.5°
1 DOWN	1 UP	2.5°
1 UP	2 UP	2.5°
2 UP	3 UP	2.5°
3 DOWN	1 DOWN	3.0°
2 DOWN	1 UP	3.0°
1 DOWN	2 UP	3.0°
1 UP	3 UP	3.0°
3 DOWN	1 UP	3.5°
2 DOWN	2 UP	3.5°
1 DOWN	3 UP	3.5°
3 DOWN	2 UP	4.0°
2 DOWN	3 UP	4.0°
3 DOWN	3 UP	4.5°

BAG-H

STEP H-07

SETUP SHEET

See Set-Up Sheet on Page 33 or hibracing.com

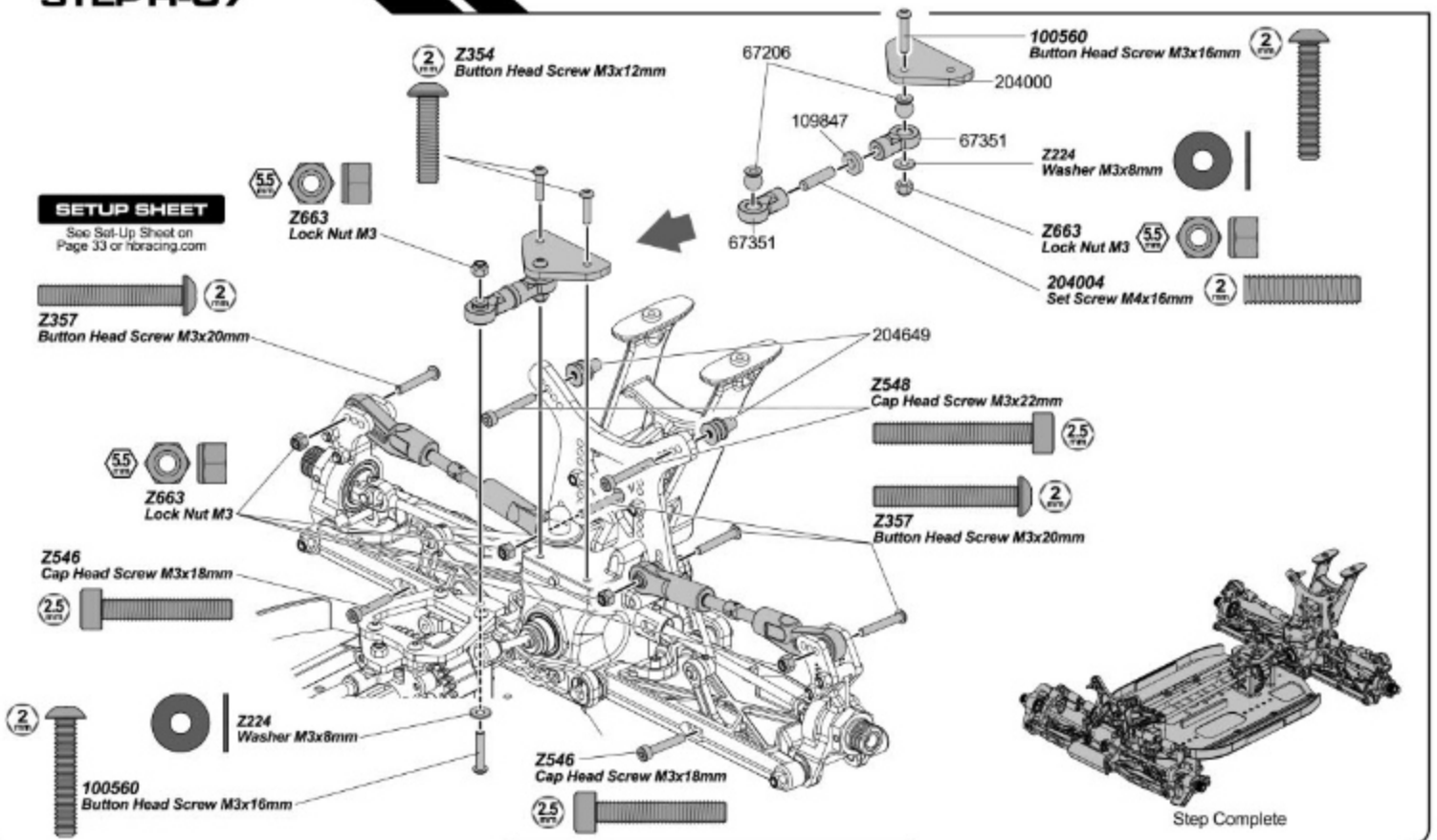

BAG-I

STEP I-01

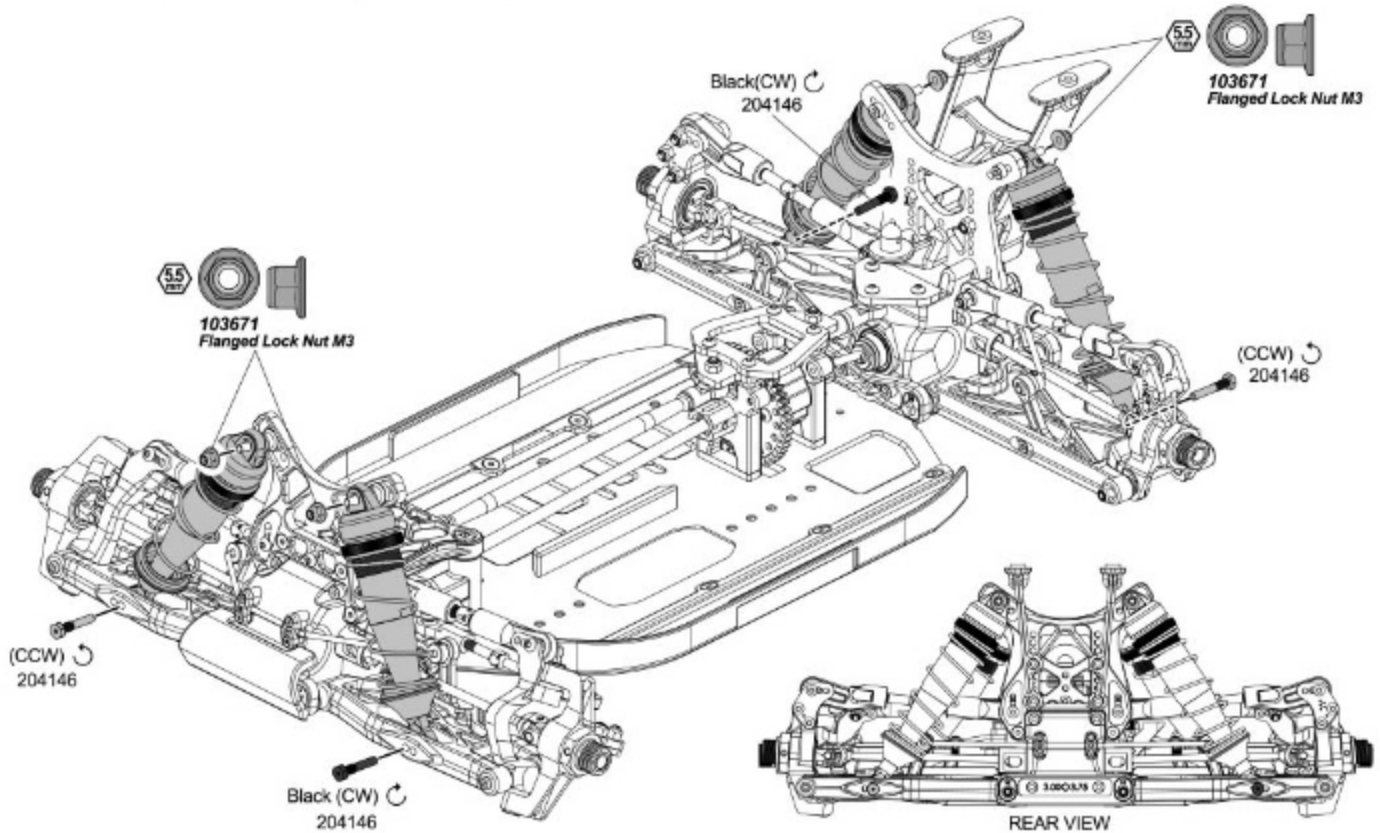

STEP J-01

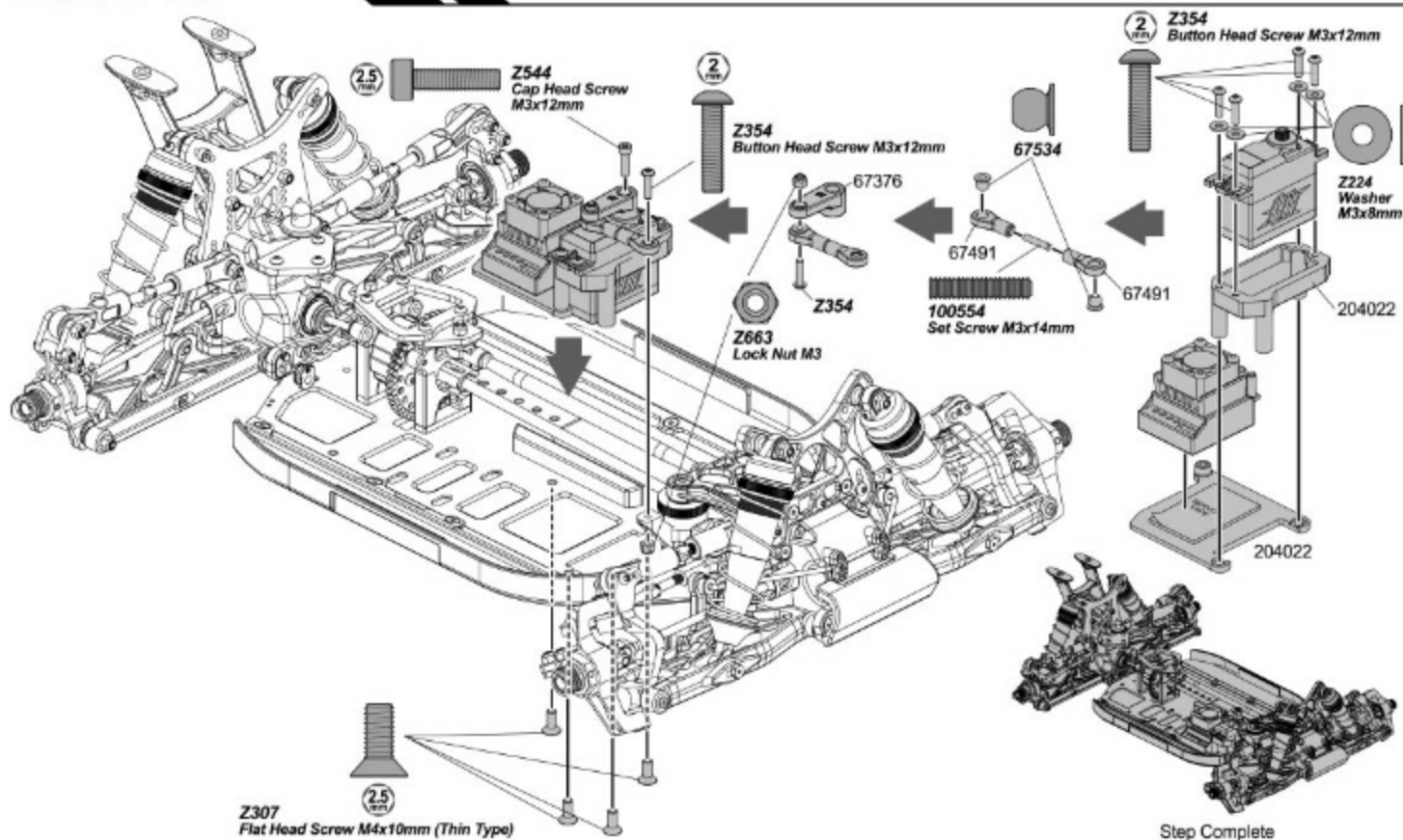

STEP J-02

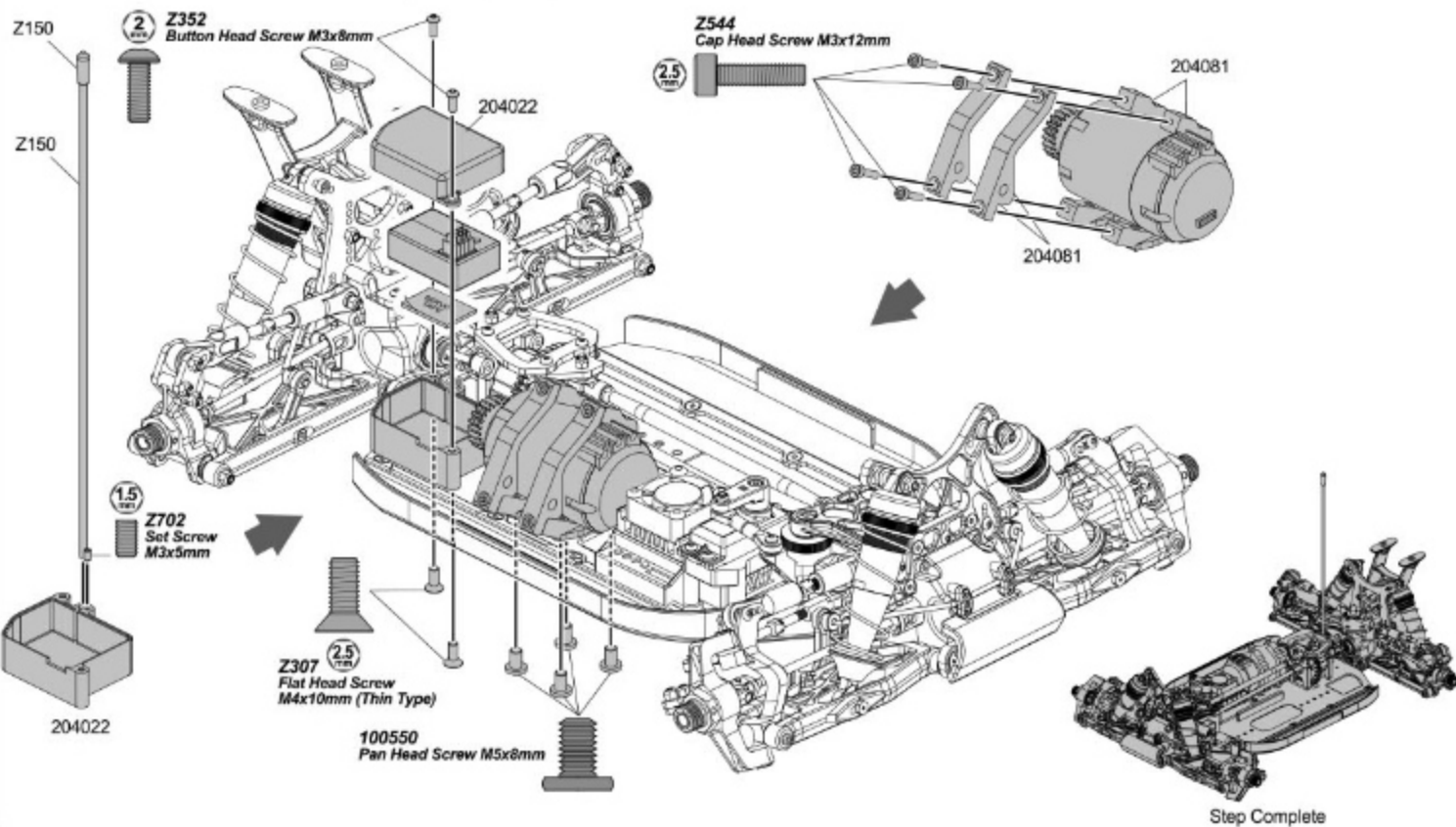

STEP J-03

BREAK-IN Z684 NUTS

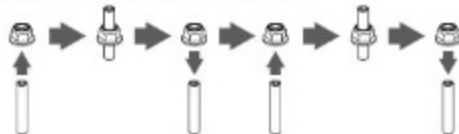

Z684
Flanged Lock Nut M4

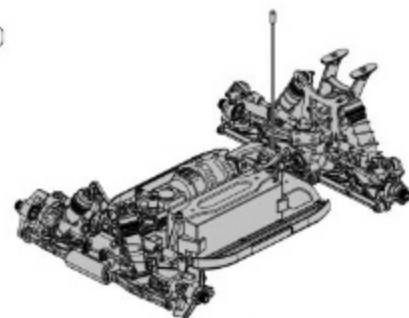
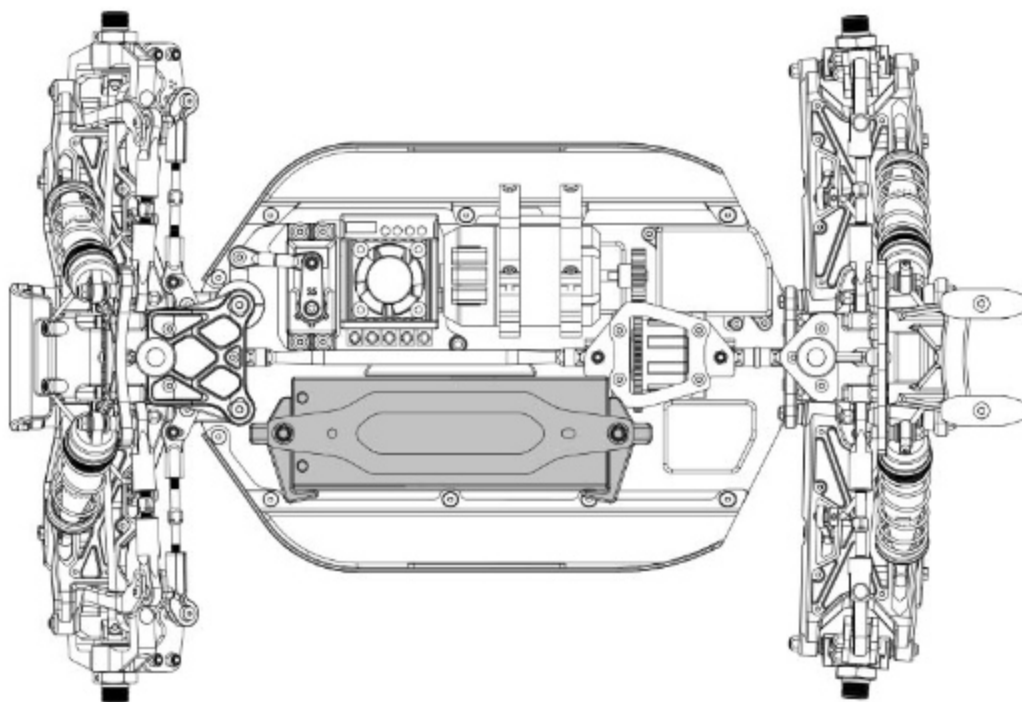
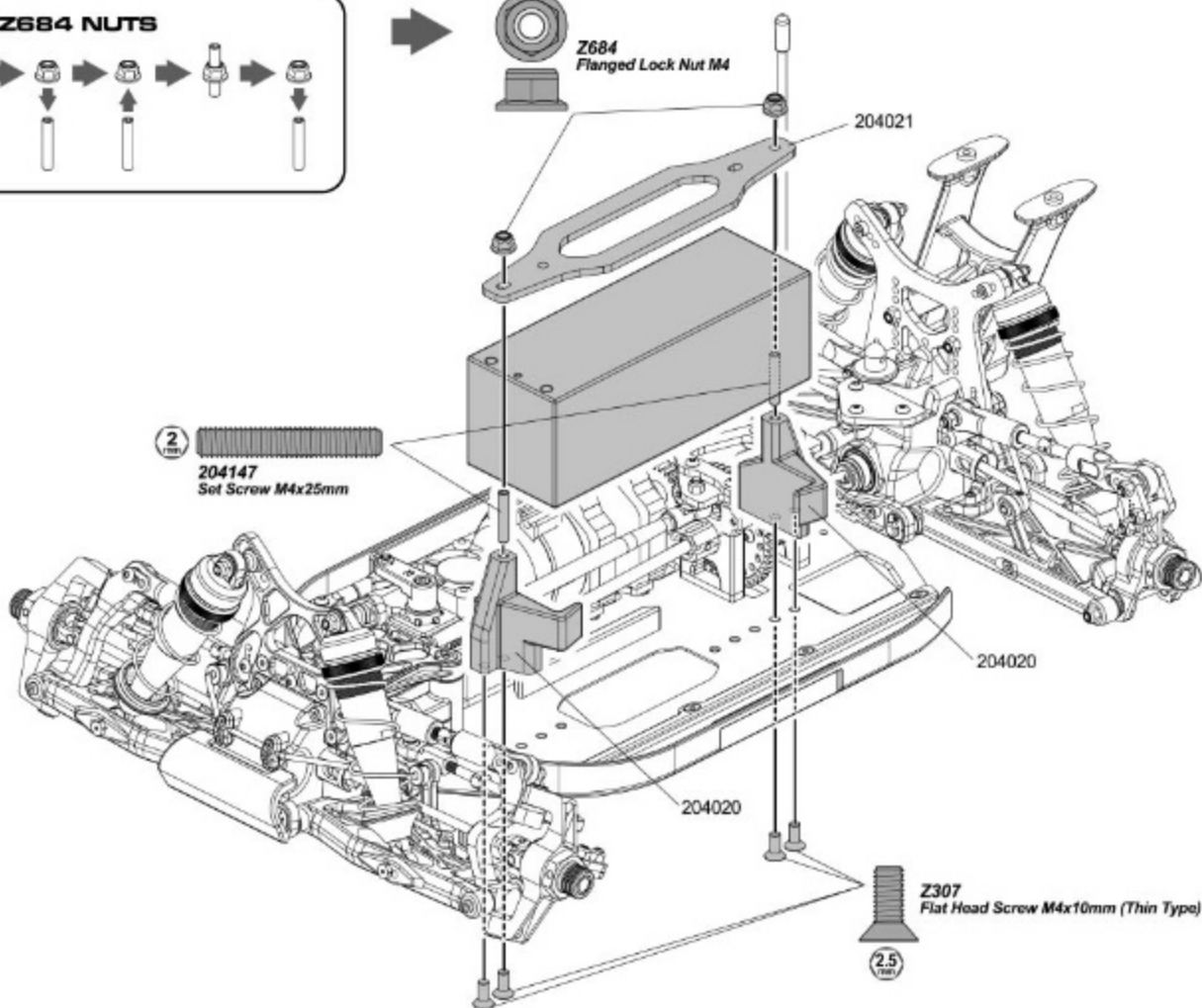

Step Complete

ADJUSTABLE SHORTY BATTERY POSITION

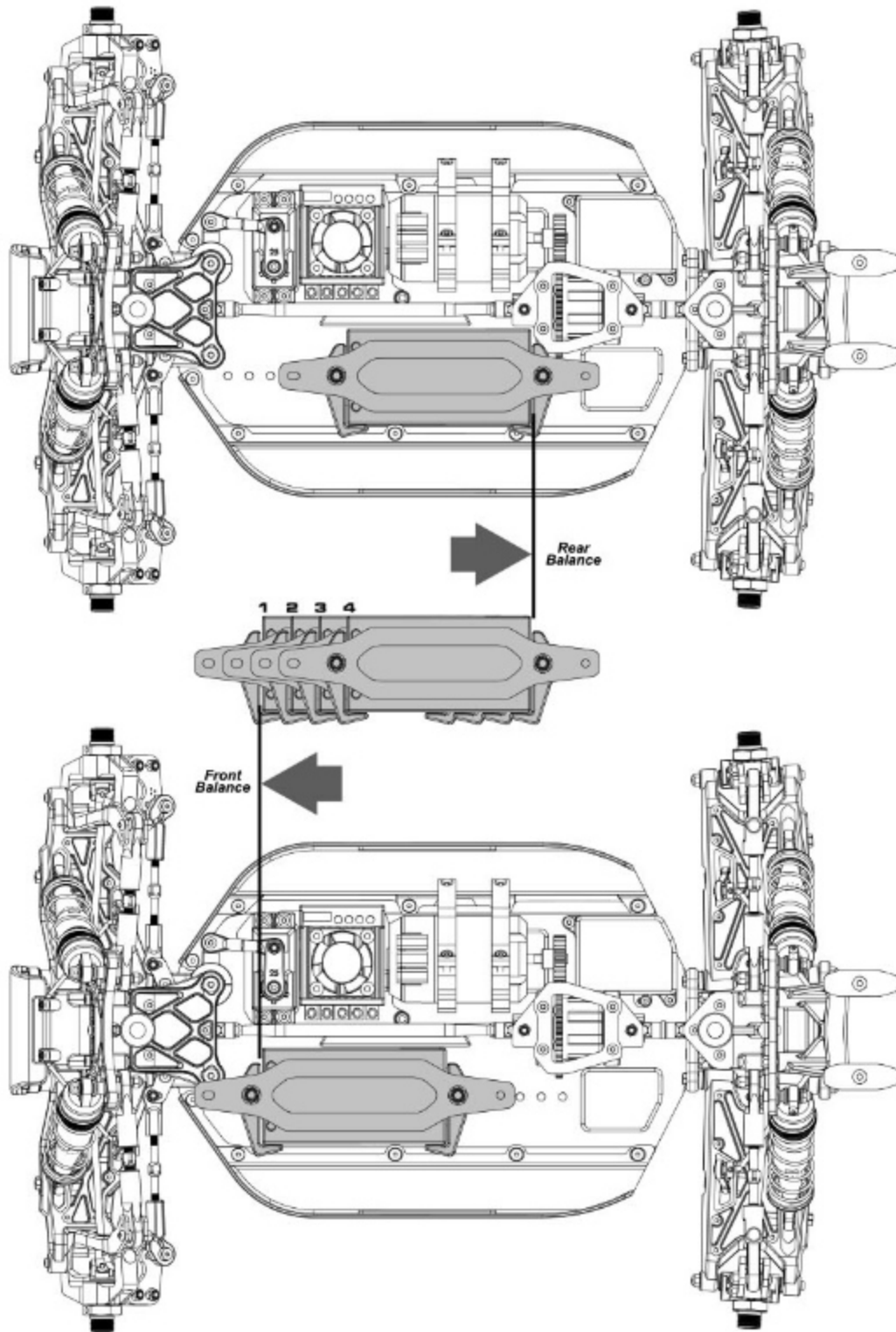

BODY

Paint inside of body with polycarbonate paint.
Trim body with a hobby knife or curved scissors.
Use a reamer for body mount holes.
Remove outer protective film before applying stickers.

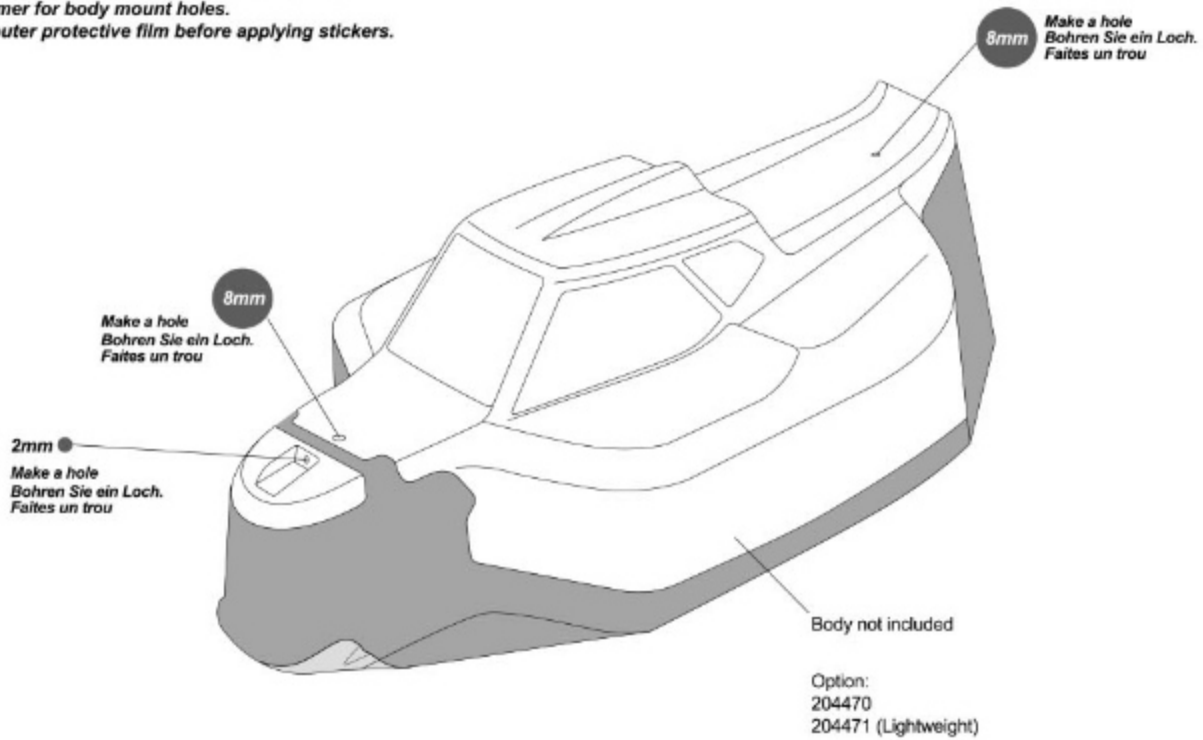

STEP K-01

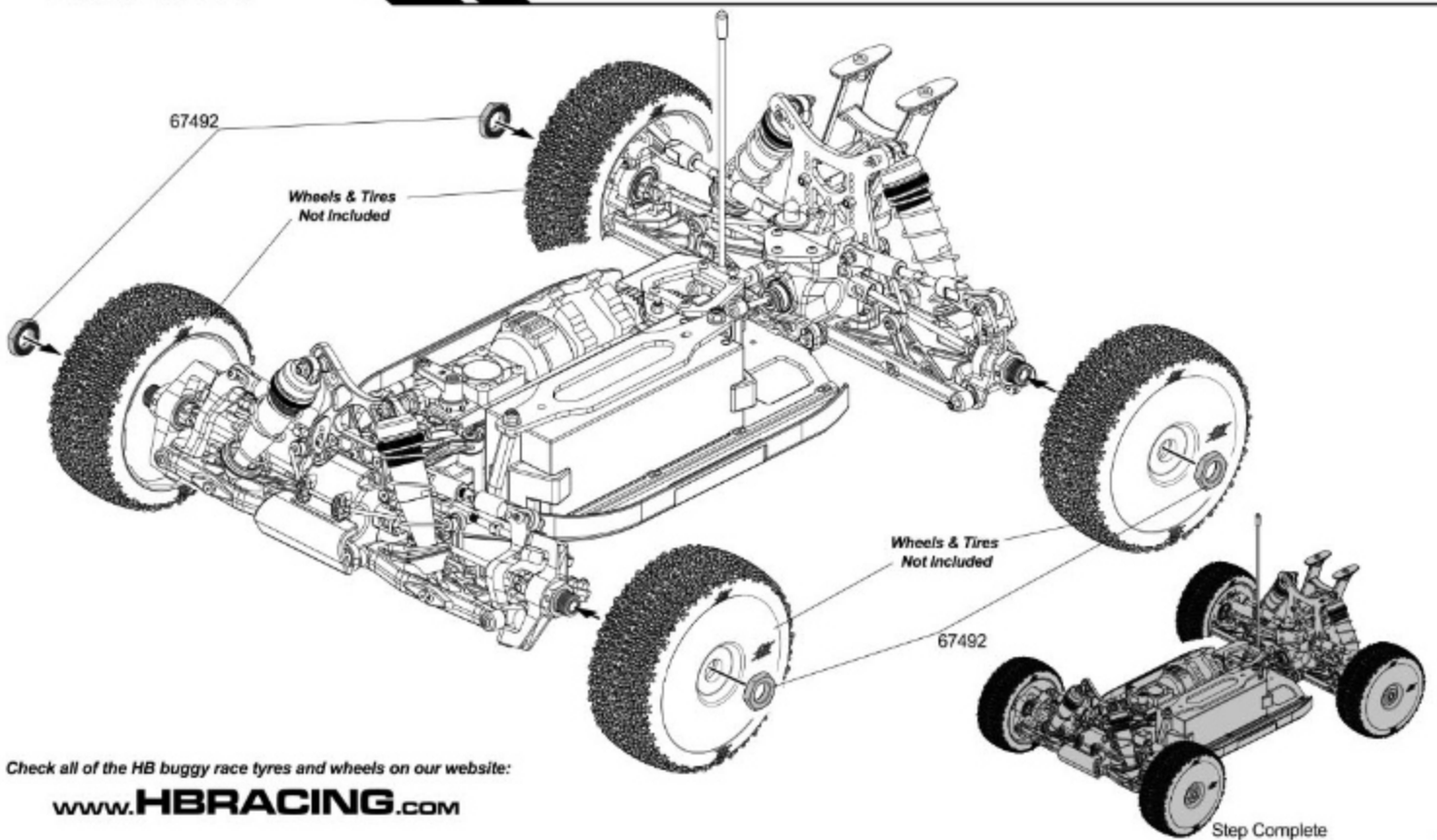

Check all of the HB buggy race tyres and wheels on our website:

www.HBRACING.com

STEP K-02

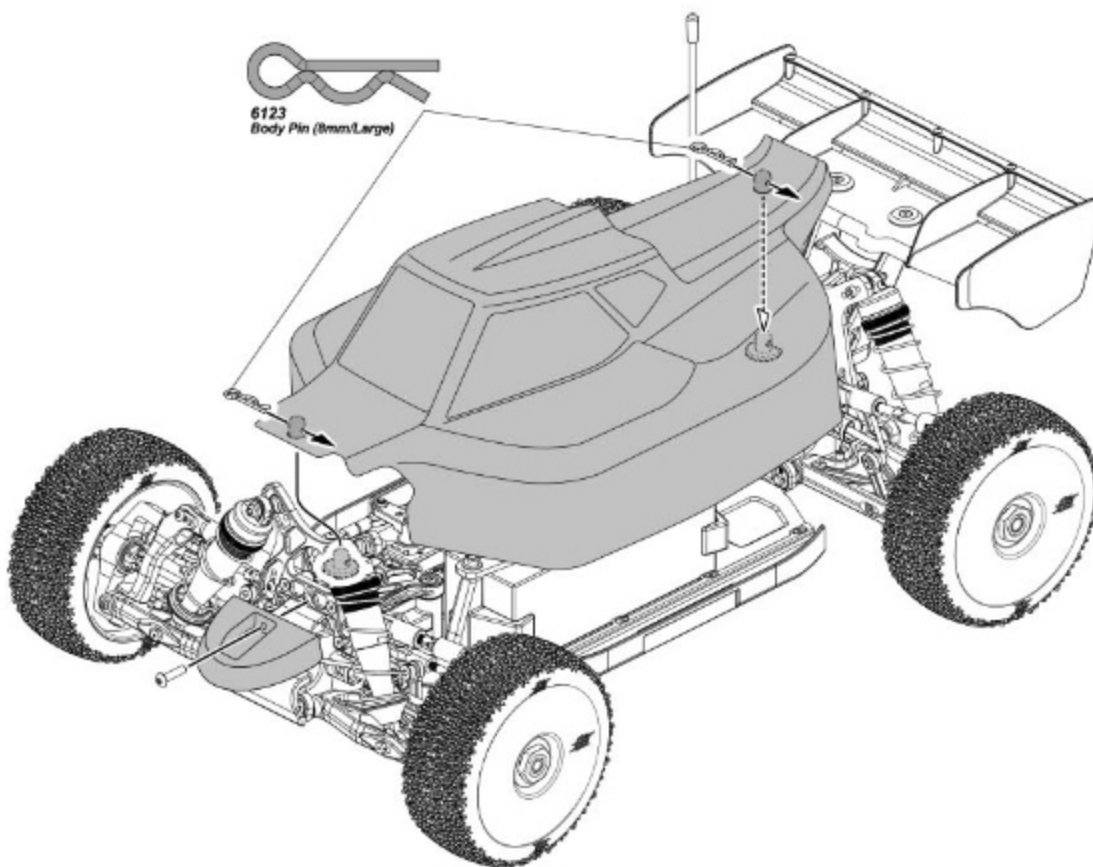
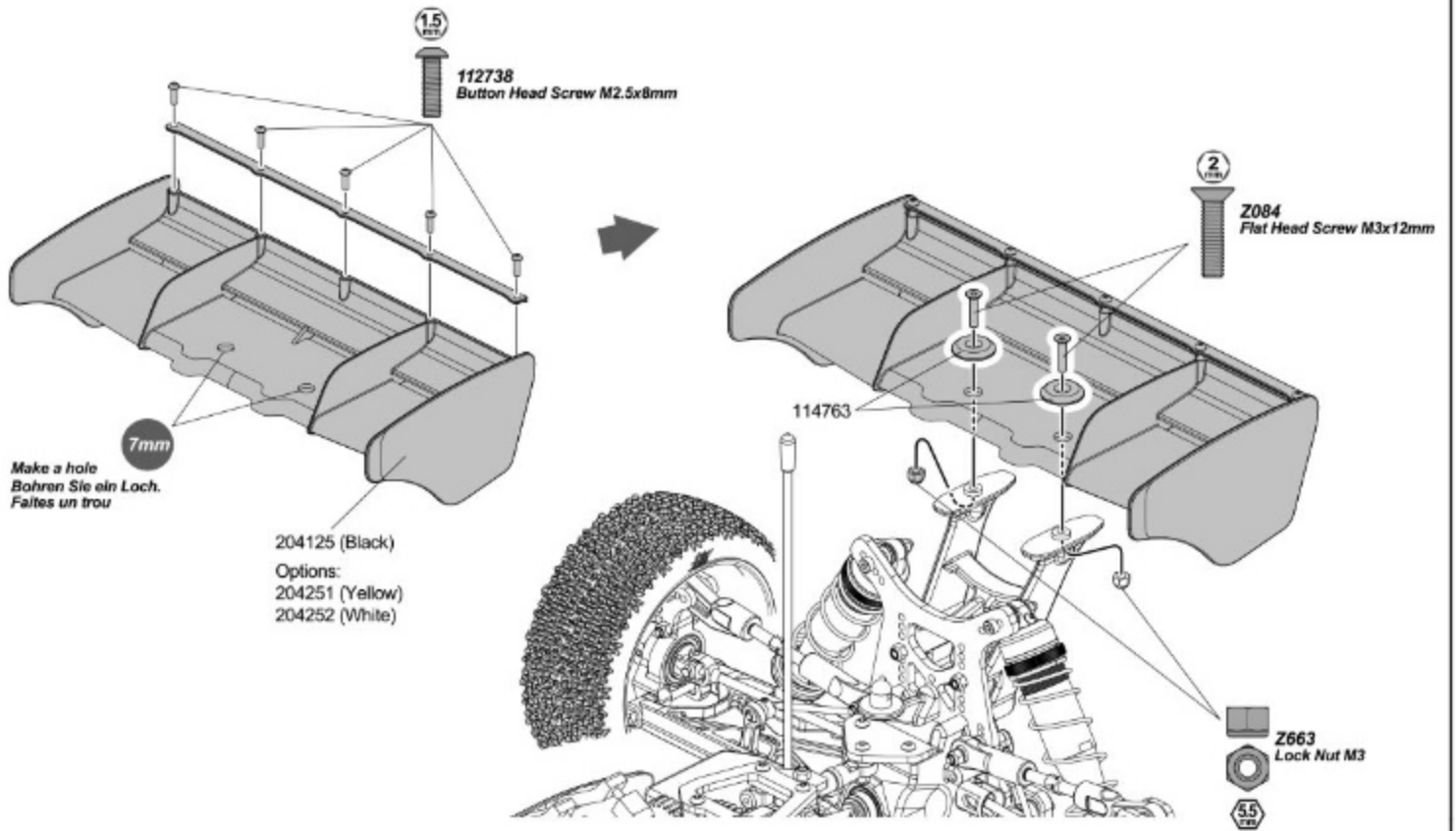

EXPLODED VIEW

Front and Rear Differential

Center Differential

Rear Shocks

Rear Differential

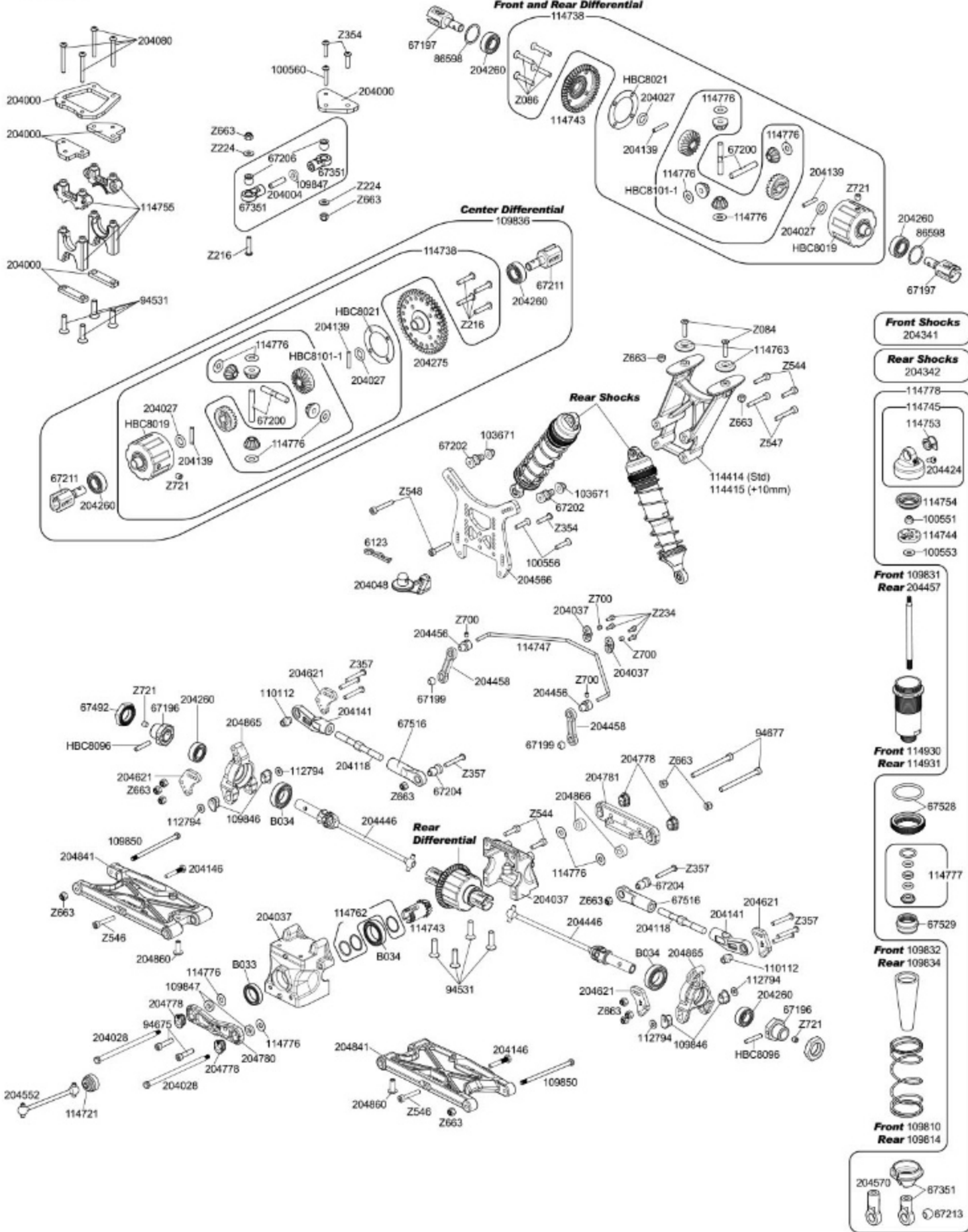

Front Shocks

Rear Shocks

- 204341
- 204342
- 114778
- 114745
- 114753
- 204424
- 114754
- 100551
- 114744
- 100553

Front

Rear

- 109831
- 204457
- 114930
- 114931

Front

Rear

- 67528
- 114777
- 67529

Front

Rear

- 109832
- 109834
- 109810
- 109814

Front

Rear

- 204570
- 67351
- 67213

Driver _____ Date _____ Track _____ Event _____

Track Condition _____

Temperature _____

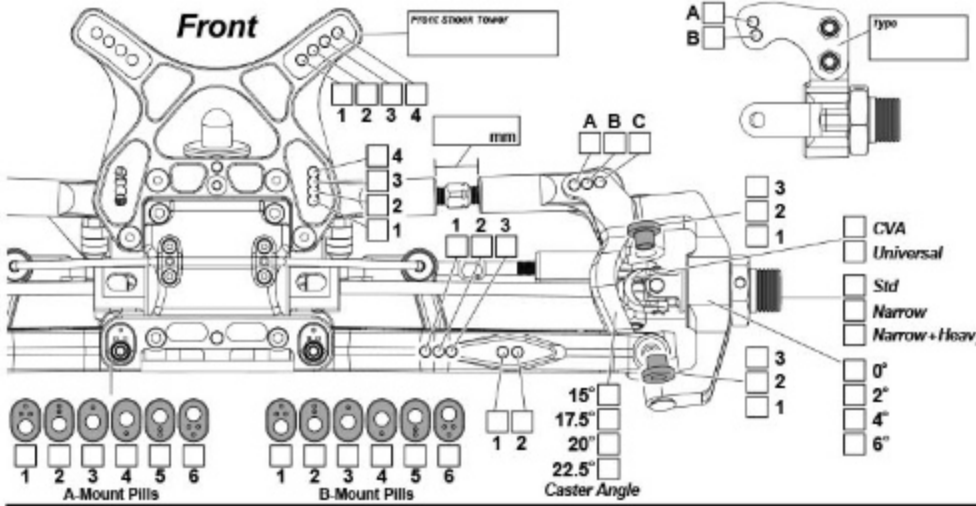

Front Shocks

Ride Height _____ mm

Camber Angle _____ °

Toe Angle _____ °

Sway Bar _____ mm

Droop _____ mm

Shock Length _____ mm

Shock Stroke _____ mm

Front Shocks

Oil weight _____ wt

Piston _____ mm

Bladder _____ mm

Spring _____ mm

Notes _____

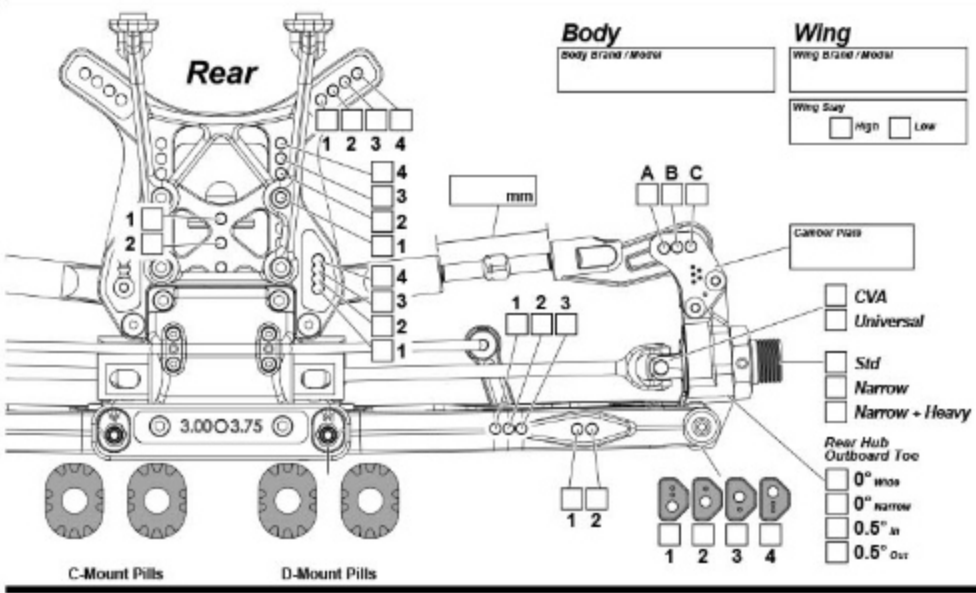

Rear Shocks

Ride Height _____ mm

Camber Angle _____ °

Toe Angle _____ °

Sway Bar _____ mm

Droop _____ mm

Shock Length _____ mm

Shock Stroke _____ mm

Rear Shocks

Oil weight _____ wt

Piston _____ mm

Bladder _____ mm

Spring _____ mm

Notes _____

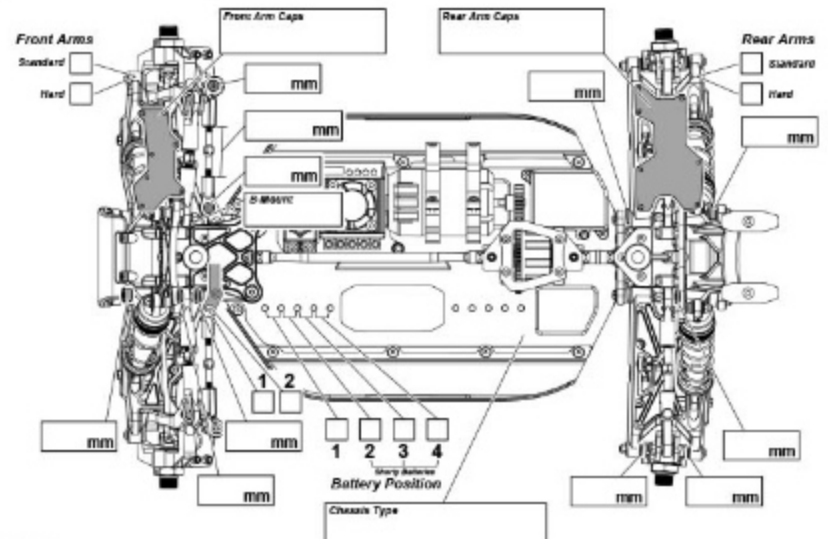

Motor

Brand / Model _____

Spur gear _____ Pinion Gear _____

Battery

Brand / Model _____

ESC

Brand / Model _____

Tires

	Front	Rear
Brand	_____	_____
Compound	_____	_____
Insert	_____	_____
Wheel	_____	_____
Notes	_____	_____

Diff Oils

	Front	Center	Rear
Brand	_____	_____	_____
Oil	_____	_____	_____

Notes _____

Driver **Standard Set-Up** Date _____ Track _____ Event _____

Track Condition _____

Temperature _____

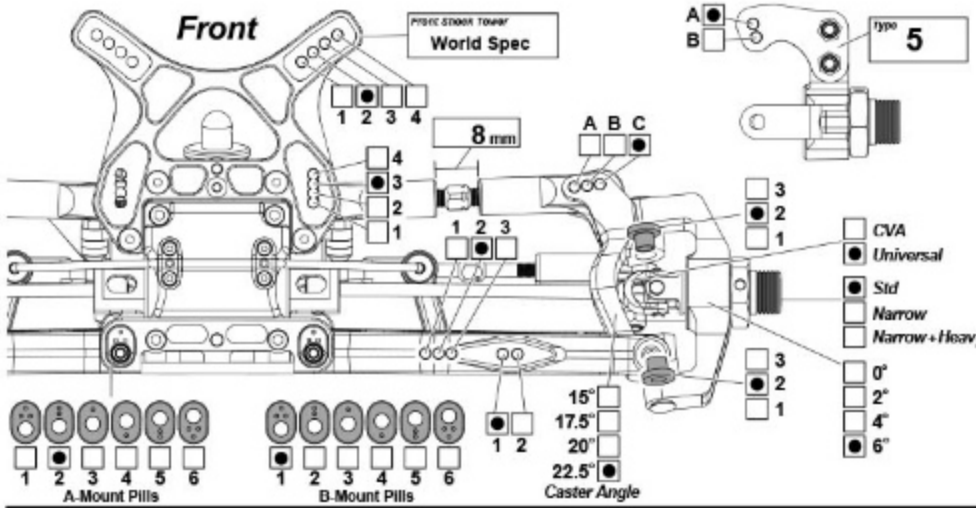

Ride Height **26 mm**

Camber Angle **-2°**

Toe Angle **-2°**

Sway Bar **2.3 mm**

Droop **0 mm**

Shock Length _____ mm

Shock Stroke **34 mm**

Front Shocks

Oil weight **45 wt**

Piston **5 x 1.5 mm**

Bladder **Std**

Spring **Gold**

Notes _____

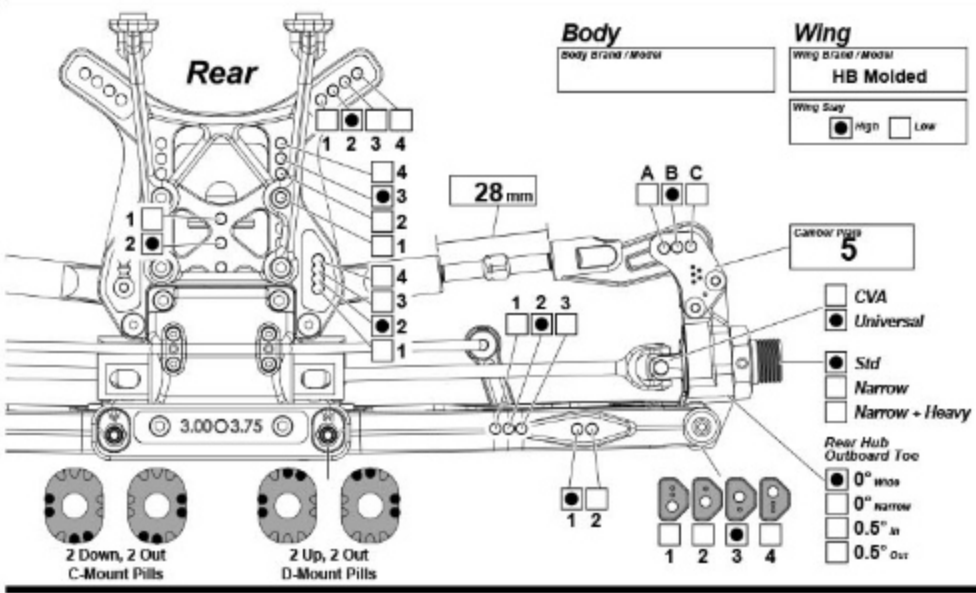

Ride Height **28 mm**

Camber Angle **-2°**

Toe Angle **3°**

Sway Bar **2.6 mm**

Droop **-5 mm**

Shock Length _____ mm

Shock Stroke **43 mm**

Rear Shocks

Oil weight **40 wt**

Piston **5 x 1.6 mm**

Bladder **Std**

Spring **Yellow**

Notes _____

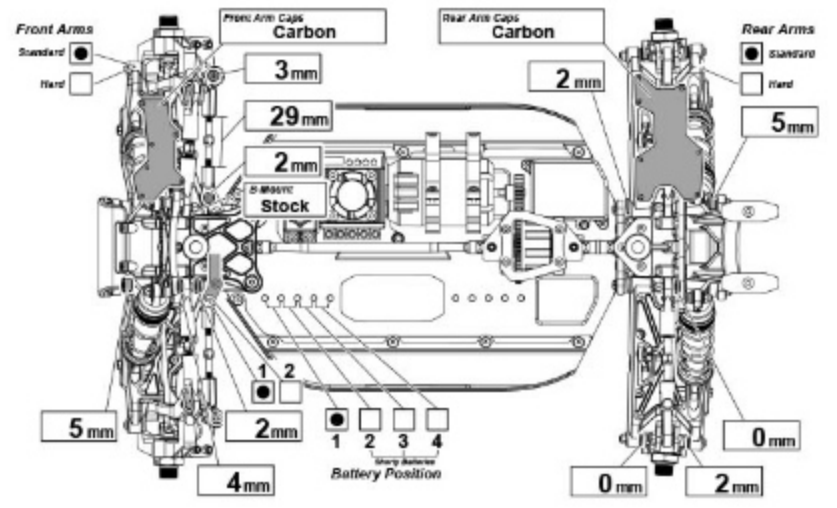

Motor

Brand / Model _____

Spur gear **48**

Pinion Gear **16**

Battery

Brand / Model _____

ESC

Brand / Model _____

Tires

	Front	Rear
Brand	_____	_____
Compound	_____	_____
Insert	_____	_____
Wheel	_____	_____
Notes	_____	_____

Diff Oils

	Front	Center	Rear
Brand	_____	_____	_____
Oil	7	7	4

Notes _____

Parts List

Parts # Description

HB114746	FRONT SWAY BAR SET V2 (2.0, 2.2, 2.4, 2.6MM)
HB114747	REAR SWAY BAR SET V2 (2.2/2.4/2.6/2.8/3.0MM)
HB100550	PAN HEAD SCREW M5X8MM (HEX SOCKET/10PCS)
HB100551	LOCK NUT M2.5 (4PCS)
HB100553	WASHER M2.9X8X0.5MM (8PCS)
HB100554	SET SCREW M3X14MM (4PCS)
HB100556	FLAT HEAD SCREW M3X14MM (HEX SOCKET/10PCS)
HB100560	BUTTON HEAD SCREW M3X16MM (HEX SOCKET/10PCS)
HB103671	FLANGED LOCK NUT M3 (10PCS)
HB109810	SHOCK SPRINGS (GOLD/68MM/79.6GF/2PCS)
HB109814	SHOCK SPRINGS (BLUE/63MM/61.6GF/2PCS)
HB109831	SHOCK SHAFT (29MM STROKE/2PCS)
HB109832	SHOCK BOOT (29MM STROKE/2PCS)
HB109834	SHOCK BOOT (38MM STROKE/2PCS)
HB109842	A-MOUNT
HB109846	HINGE PIN BUSHING SET
HB109847	PLASTIC SPACER SET
HB109849	HINGE PIN SET (FRONT OUTER 2PCS)
HB109850	HINGE PIN SET (REAR OUTER 2PCS)
HB109851	BUMPER
HB110112	ALUMINIUM BALL 6.8X9X3MM (4PCS)
HB112738	BUTTON HEAD SCREW M2.5X8MM (HEX SOCKET/10PCS)
HB112794	WASHER SET 3X7MM (0.5MM/1.0MM/ORANGE/6PCS)
HB114415	WING MOUNT V2 (+10MM)
HB114721	AXLE BOOT (CENTER/REAR/4PCS)
HB114743	DIFF RING / INPUT GEAR SET (43/13)
HB114744	SHOCK PISTON SET V2 (16MM/ORANGE/6 PAIRS)
HB114749	ALUMINIUM SERVO SAVER ARM (BLACK)
HB114751	SERVO SAVER DUST COVER (4PCS)
HB114752	STEERING BRACE V2
HB114753	SHOCK CAP BUSHING (4PCS)
HB114754	SHOCK BELLOWS BLADDER (4PCS)
HB114755	CENTER BULKHEAD SET
HB114761	BUTTON HEAD SCREW M2.5X8MM (HEX SOCKET/10PCS)
HB114762	INPUT SHAFT CLIP/SHIM SET (4PCS)
HB114763	ALUMINIUM WING MOUNT WASHER (BLACK/2PCS)
HB114776	SHIM 4X10X0.3MM (12PCS)
HB114777	SHOCK CARTRIDGE MAINTENANCE SET (1 PAIR)
HB114930	BIG BORE SHOCK BODY 29MM (2PCS)
HB114931	BIG BORE SHOCK BODY 38MM (2PCS)
HB204000	CHASSIS BRACE CARBON SET (E817)
HB204004	SET SCREW M4X16MM (6PCS)
HB204016	UNIVERSAL SET (FRONT)
HB204017	CHASSIS GUARD SET
HB204018	FLUSH MOUNT FASTENER SCREW (M3.0/10PCS)
HB204020	BATTERY HOLDER SET (E817)
HB204021	BATTERY STRAP (E817)
HB204022	ELECTRONICS MOUNT SET (E817)
HB204027	DIFF O-RINGS V2 (6MM/10PCS)
HB204028	HINGE PIN INNER (2PCS/817/819 SERIES)
HB204037	D8 SERIES GEARBOX SET (NEW)
HB204048	BODY MOUNT SET (817 SERIES)
HB204080	BUTTON HEAD SCREW M3X25MM (6PCS)
HB204081	MOTOR MOUNT SET (E817)
HB204083	FOAM ADHESIVE PAD (E817)
HB204118	TURNBUCKLE M5 X 59MM (2PCS)
HB204125	1:8 REAR WING (BLACK)
HB204139	PIN 2.5 X 14MM (6PCS)
HB204141	BALL END 6.8 X M5 (OFFSET) (2PCS)
HB204146	SCREW TYP SHOCK PIN SET (LHX2 / RHX2)
HB204147	SET SCREW M4X25MM
HB204242	DOGBONE 185MM HD (SHORT PIN)
HB204260	BALL BEARING 8X16X5MM V2 (2PCS)
HB204275	HEAVY DUTY SPUR GEAR (48T)
HB204424	BIG BORE SHOCK CAP SET V3 (2PCS)
HB204446	REAR UNIVERSAL SET 93.0MM
HB204456	SWAYBAR PIVOT BALL V2 SET
HB204457	38MM STROKE SHOCK SHAFT (+5MM EXTENSION/2PCS)
HB204458	1-PC SWAYBAR LINK (2PCS)
HB204552	E819 REAR CENTER DOGBONE (36MM)
HB204562	SERVO SAVER TUBE
HB204566	REAR SHOCK TOWER V3
HB204569	SERVO SAVER SPRING (HARD)
HB204570	SHOCK END V2 (LONG/4PCS)
HB204577	FRONT CHASSIS BRACE HD
HB204583	43T DIFF RING GEAR (FOR 13T INPUT GEAR)
HB204595	CLAMPING SERVO SAVER NUT V2
HB204615	STEERING ARM TYPE 4
HB204616	STEERING RACK
HB204617	STEERING RACK BUSHING
HB204621	HUB ARM SET TYPE 5
HB204649	SHOCK STANDOFF 9MM ALUMINIUM (2PCS)
HB204655	KINGPIN V3 SET
HB204656	STEERING BLOCK BUSHING SET 1:8 (4PCS +1MM / 2PCS 0MM / 2PCS +2MM)
HB204778	HINGE PIN BUSHING SET V2

Parts # Description

HB204779	B-MOUNT V2
HB204780	C-MOUNT V2 (-.75 - +0)
HB204781	D-MOUNT V2 (3.00-3.75)
HB204782	TURNBUCKLE M5 X 38MM
HB204840	FRONT SUSPENSION ARM SET (2PCS/D8 EVO)
HB204841	REAR SUSPENSION ARM SET (2PCS/D8 EVO)
HB204846	CASTER BLOCK SET LIGHTWEIGHT (22.5 DEGREE)
HB204847	STEERING BLOCK SET LIGHTWEIGHT (6 DEGREE)
HB204860	D8 DROOP SCREW V2
HB204865	HUB CARRIER LIGHTWEIGHT
HB204866	ARM SPACER 5MM (4PCS)
HB204867	CHASSIS E8 WORLD SPEC
HB204869	FRONT SHOCK TOWER (TALL)
HB204870	FLANGED BALL (7 X 12.5)
HB204871	WASHER (M3 X 7 X 2)
HB66247	STEERING BALLEND 6.8MM (4PCS)
HB67195	LIGHTWEIGHT STEERING POST (2PCS)
HB67196	LIGHTWEIGHT WHEEL HEX HUB (2PCS)
HB67197	LIGHTWEIGHT OUTDRIVES (2PCS)
HB67199	LIGHTWEIGHT BALL (6MM/4PCS)
HB67200	LIGHTWEIGHT DIFFERENTIAL SHAFT (2PCS)
HB67202	LIGHTWEIGHT SHOCK STAND OFF (2PCS)
HB67204	LIGHTWEIGHT FIXING BALL (4PCS)
HB67206	LIGHTWEIGHT STEERING PUSH ROD BALL (4PCS)
HB67211	LIGHTWEIGHT DIFF AXLE SHAFT (2PCS)
HB67213	LIGHTWEIGHT SHOCK END BALL (4PCS)
HB67351	SHOCK END/SHOCK SPRING RETAINER SET
HB67376	SERVO ARM SET
HB67394	SERVO SAVER CRANK SET
HB67464	STEERING TURNBUCKLE 4X55MM (2PCS)
HB67491	STEERING LINKAGE SET
HB67516	BALL END SET
HB67528	BIG BORE SHOCK SPRING ADJUST NUT (BLACK/2PCS)
HB67529	BIG BORE SHOCK BOTTOM CAP (BLACK/2PCS)
HB67534	BALL 5.8X5.6MM (4PCS)
HB66598	WASHER 13X16X0.2MM (10PCS)
HB94531	FLAT HEAD SCREW M4X15MM (HEX SOCKET/10PCS)
HB94554	BUTTON HEAD SCREW M4X10MM (HEX SOCKET/10PCS)
HB94675	CAP HEAD SCREW M3.5X14MM (8PCS)
HB94677	CAP HEAD SCREW M3.5X42MM (8PCS)
HBB028	BALL BEARING 6X10X3MM (2PCS)
HBB033	BALL BEARING 12X18X4MM (2PCS)
HBB034	BALL BEARING 12X21X5MM (2PCS)
HBC8019	DIFFERENTIAL HOUSING
HBC8021	DIFFERENTIAL PADS
HBC8022	DIFFERENTIAL SHAFT
HBC8096	3X17MM SHAFT (4PCS)
HBC8100	6.8MM BALL END (L) (4PCS)
HBC8101-1	HARD STEEL DIFFERENTIAL GEAR SET
HBZ084	FLAT HEAD SCREW M3X12MM (HEX SOCKET/10PCS)
HBZ086	FLAT HEAD SCREW M3X18MM (HEX SOCKET/10PCS)
HBZ087	FLAT HEAD SCREW M3X20MM (HEX SOCKET/10PCS)
HBZ150	ANTENNA PIPE SET
HBZ216	BUTTON HEAD SCREW M3X15MM (HEX SOCKET/4PCS)
HBZ224	WASHER M3X8MM (10PCS)
HBZ234	CAP HEAD SCREW M2X5MM (10PCS)
HBZ307	FLAT HEAD SCREW M4X10MM (HEX SOCKET/THIN TYPE/4PC)
HBZ352	BUTTON HEAD SCREW M3X8MM (HEX SOCKET/10PCS)
HBZ353	BUTTON HEAD SCREW M3X10MM (HEX SOCKET/10PCS)
HBZ354	BUTTON HEAD SCREW M3X12MM (HEX SOCKET/10PCS)
HBZ356	BUTTON HEAD SCREW M3X18MM (HEX SOCKET/10PCS)
HBZ357	BUTTON HEAD SCREW M3X20MM (HEX SOCKET/10PCS)
HBZ544	CAP HEAD SCREW M3X12MM (6PCS)
HBZ546	CAP HEAD SCREW M3X18MM (10PCS)
HBZ547	CAP HEAD SCREW M3X20MM (6PCS)
HBZ548	CAP HEAD SCREW M3X22MM (12PCS)
HBZ663	LOCK NUT M3 (6PCS)
HBZ676	LOCK NUT M3 THIN TYPE (4PCS)
HBZ684	FLANGED LOCK NUT M4 (4PCS)
HBZ700	SET SCREW M3X3MM (6PCS)
HBZ702	SET SCREW M3X5MM (10PCS)
HBZ721	SET SCREW M4X4MM (4PCS)
HBZ722	SET SCREW M4X5MM (8PCS)

Option Parts List

Parts #	Description	Parts #	Description
HB109806	SHOCK SPRINGS (GREEN/68MM/60.8GF/2PCS)	HB204673	STEERING ARM TYPE 1
HB109807	SHOCK SPRINGS (WHITE/68MM/64.6GF/2PCS)	HB204674	STEERING ARM TYPE 2
HB109808	SHOCK SPRINGS (BLUE/68MM/68.9GF/2PCS)	HB204675	STEERING ARM TYPE 3
HB109809	SHOCK SPRINGS (YELLOW/68MM/73.8GF/2PCS)	HB204676	STEERING ARM TYPE 5
HB109811	SHOCK SPRINGS (RED/68MM/86.1GF/2PCS)	HB204677	STEERING ARM TYPE 6
HB109812	SHOCK SPRINGS (GREEN/83MM/54.7GF/2PCS)	HB204678	HUB ARM SET TYPE 1
HB109813	SHOCK SPRINGS (WHITE/83MM/57.9GF/2PCS)	HB204679	HUB ARM SET TYPE 2
HB109815	SHOCK SPRINGS (YELLOW/83MM/65.7GF/2PCS)	HB204680	HUB ARM SET TYPE 3
HB109816	SHOCK SPRINGS (GOLD/83MM/70.3GF/2PCS)	HB204681	HUB ARM SET TYPE 4
HB109817	SHOCK SPRINGS (RED/83MM/75.8GF/2PCS)	HB204686	CHASSIS WEIGHTS SET (3X9G / 1:8 BUGGY)
HB109841	LIGHTWEIGHT SPUR GEAR (48T)	HB204842	WOVEN GRAPHITE ARM COVERS (FRONT)
HB109843	ARM MOUNT (B/0MM)	HB204843	WOVEN GRAPHITE ARM COVERS (REAR)
HB113476	SHOCK SPRINGS (ORANGE/83MM/82.1GF/2PCS)	HB204848	FRONT SWAY BAR SET (1.8, 1.9, 2.1MM)
HB114201	1/8 BUGGY DISH WHEELS V2 (WHITE/4PCS)	HB204861	STEERING BLOCK SET LIGHTWEIGHT (0 DEGREE)
HB114202	1/8 BUGGY DISH WHEELS V2 (YELLOW/4PCS)	HB204862	STEERING BLOCK SET LIGHTWEIGHT (2 DEGREE)
HB114414	WING MOUNT V2 (STANDARD)	HB204863	STEERING BLOCK SET LIGHTWEIGHT (4 DEGREE)
HB114487	ALUMINUM WASHER 3X6X0.5MM (ORANGE/20PCS)	HB204873	CASTER BLOCK SET LIGHTWEIGHT (17.5 DEGREE)
HB114488	ALUMINUM WASHER 3X6X0.75MM (ORANGE/20PCS)	HB204874	CASTER BLOCK SET LIGHTWEIGHT (20 DEGREE)
HB114490	ALUMINUM WASHER 3X6X1.5MM (ORANGE/20PCS)		
HB204015	UNIVERSAL SET (REAR 91.5MM)		
HB204029	PIN 2.5X12MM (5PCS)		
HB204042	SPUR GEAR 59T MODULE 0.8		
HB204043	SPUR GEAR 60T MODULE 0.8		
HB204251	1:8 REAR WING (YELLOW)		
HB204252	1:8 REAR WING (WHITE)		
HB204327	RIDE HEIGHT GAUGE (15-45MM)		
HB204341	FRONT SHOCK KIT V2		
HB204342	REAR SHOCK KIT V2		
HB204436	SILENCER BUGGY BODYSHELL LIGHTWEIGHT (JCONCEPTS)		
HB204444	FRONT SWAY BAR SET V2 (2.3, 2.5MM)		
HB204445	REAR SWAY BAR SET V2 (2.5, 2.7MM)		
HB204470	S15 BUGGY BODYSHELL STANDARD (JCONCEPTS)		
HB204471	S15 BUGGY BODYSHELL LIGHTWEIGHT (JCONCEPTS)		
HB204476	ARM MOUNT 2-DOT (B/+0.7MM)		
HB204478	LIGHTWEIGHT WHEEL HEX HUB 2PCS (NARROW)		
HB204479	BRASS WHEEL HEX HUB 2PCS (NARROW)		
HB204554	E819 ALUMINUM SERVO MOUNT		

Notes

Serial Number
Seriennummer
Numéro de série
シリアルナンバー



www.hbracing.com
Neidhart SA
Ch. du Pré-Fleuri 31
CH-1228 Plan-les-Ouates
Switzerland
Phone: +41 22 706 18 50